



# Construction

Healthy Business

**Dustcontrol**®

# Dustcontrol – Technology for Healthy Business

Removing dust from the workplace is not just a working environment and health issue, it is also a business issue. The cleaner the working environment, the better the end result. We call it **Healthy Business**.

## What we offer

Dustcontrol manufactures mobile dust extractors for industrial and construction use, fixed extraction systems, peripheral equipment and accessories. We help companies all over the world to achieve a cleaner working environment. Our development department and production facilities are located in Sweden.

Using one of our solutions, you can extract dust, fumes, chips, oil spillages and other harmful substances, right at their source. The result is efficient production. A healthy working environment results in less absence due to illness, more efficient production, less downtime and better production quality.

You will find us in many different types of industries where a clean working environment is necessary. Dustcontrol supplies a complete range of products and accessories for small and large companies alike. For example, we supply advanced cleanroom solutions for the pharmaceutical and electronics industries, mobile dust extractors of various sizes for construction and rental companies, and central extraction systems for the automotive and newspaper printing industries.

All of our systems are unique and tailored to each individual company's specific requirements.



## Customer Focus

Dustcontrol was founded in 1972, with the idea of manufacturing extraction systems to capture dust and other pollutants at the source. We work closely with our customers, which means that we are always up to date regarding the requirements, regulations and working conditions in different types of workplace. We supply products that meet these ever-changing needs.

But it is not only products that we provide. We also provide the answers to questions such as: How can you capture and extract different kinds of particles and pollutants in the best possible way for your business? How do you deal with waste that can be recycled or reused?



The filter systems in all Dustcontrol dust extractors are built to comply with the the stringent IEC machine classification H.

All our mobile machines are equipped with a fine filter and a HEPA filter (H13) that clean the exhaust air to 99.95 %. These high-efficiency filters also have a long service life, which not only results in cleaner air, but also low filter costs.

With Dustcontrol as your business partner, you will get the answers to these and any other questions that you may have. Whatever the conditions, we develop a source extraction solution that is right for you and your business.

## Service & Expertise

Our sales organisation comprises experienced technicians with specialist skills in their areas of expertise. If you need a mobile solution, we will come to your site and show you how it works. In the case of stationary installations, we can design and dimension the entire system to fully match your needs. We can take care of installation, commissioning and documentation, as well as planning a maintenance and service schedule.

We offer a complete service package, including accessories and spare parts. We manufacture and customise portable dust extractors with very high levels of filtration, in which we use our proprietary filters that have set the industry standard.

As well as being responsible for delivery and installation, our project managers also train the personnel who will be working with our products and systems. In most countries, we have our own team of qualified installers with in-depth knowledge of our products.

With the help of Dustcontrol, you will achieve both a cleaner working environment and a healthy business.

## Dustcontrol AB

160 employees.

Founded in 1972.

Head office and factory  
in Norsborg, Sweden.

The company is family-owned.

Turnover approx. 30 million Euro.

Subsidiaries in the United Kingdom,  
Germany, Austria, USA and Finland.

Distributors in Europe, Asia-Pacific  
and North & South America.



# Our Symbols



Dustcontrol's 1-phase, single-motor dust extractor.



Dustcontrol's 1-phase, twin-motor dust extractor.



Dustcontrol's 3-phase.



The filter systems in all Dustcontrol dust extractors are built to comply with the the stringent IEC machine classification H.



The article is also available in antistatic (ESD) version.



The dust extractor includes an eco-green motor.



The dust extractor is a 1-phase power system.



The dust extractor is a 3-phase power system.



DGUV Test: Warning label

The dust extractor has been DGUV tested and approved by IFA (Institut für Arbeitsschutz der Deutschen Gesetzlichen Unfallversicherung).



Warning label that the dust extractor can contain asbestos and you need to follow safety instruction.



# Index

**Machines for Every Job**  
**Choose the Right Machine**

6-7

8-9

**Dustcontrol Air Cleaners** 44-47

DC AirCube 500 46

DC AirCube 1200/2000 47

**Decontamination Systems** 49-51

DC Decontamination Box 50-51

**Dustcontrol Pre-Separators** 52-53

DCF 2800 & DCF 3900 54

DCF Storm & DCF 60 55

DCF Cyclone Separator Cover 55

DCF Wheelbarrow 56

DCF Tipping Container 56

**The Most Dangerous Dust** 57  
**is the DustYou Can't See**

**Classification of Dust** 58-59  
**Extractors & HEPA Filters**

**Accessories and Hoses** 60-81

Suction Casings 69-75

Choose the Right Filter 76-77

Filters 78-80

Bags 81

**Our Worldwide Distributors** 83

**Environmental & Quality Policy** 84

**MINI**  
**Dustcontrol Mini**

10-15

DC 1800 12

DC 1800XL 12

DC 2900c 13

DC 2900a 13

DC 1800H Asbestos 14

DC 2800H Asbestos 15

**MIDI**  
**Dustcontrol Midi**

16-26

DC Tromb 400H Asbestos 17

DC 3900a/c/L 18-19

DC 3900L Twin 22

DC 3900c Twin 22

DC 3900c Turbo 23

DC 3900c Twin Turbo 23

DC Tromb Twin , DC Tromb 400  
and DCF Tromb 24-25

DC 3900 Wood Shaving 26

DC 4000 PCB 26

**MAXI**  
**Dustcontrol Maxi**

27-37

DC Storm 500/600/700 28-33

DC 5900 9.2kW S/P 34-35

DC 5900H Asbestos 35

DC Storm LPG 36-37

**Compare our Dust Extractors** 38-39

**Semi-Mobile Systems** 40-47

**Dustcontrol Wet-Vacs** 42-43

# Machines for every ⚡💣!☠️🔥# job

No matter who you are and what type of work you are involved in, we have exactly the right machines for you and the job that you do. Small and agile or big and powerful? Only you know which Dustcontrol machine is the right one for you.

Floor Finisher

Drilling Specialist

Decontamination  
and Abatement  
Specialist







Construction Worker

Carpenter

Painter

# Choose the Right Machine

## Task or tool

|                          |                                  |
|--------------------------|----------------------------------|
| Drilling                 | Small crosscut and               |
| Cleaning Ø38 mm/1.5"     | mitre saw, jackhammer            |
| Reciprocating saw        | Personal decontamination         |
| Jig saw                  | Depressed centre disc Ø125 mm/5" |
| Abrasive disc Ø125 mm/5" | Wall sander Ø125 mm/5"           |
| Fibre disc Ø125 mm/5"    | Oscillating machine              |

## Task or tool

|   |                          |
|---|--------------------------|
| Depressed centre disc Ø230mm/9"           | Abrasive disc Ø230 mm/9" |
| Grooving saw 2xØ150mm/6"                  | Concrete milling machine |
| Jackhammer                                | Chipping hammer          |
| Circular saw                              | Cleaning Ø50 mm/2"       |
| Concrete floor grinding<br>max 500 mm/19" | Filler sanding           |

## Task or tool

|   |                       |
|---|-----------------------|
| Concrete floor grinding<br>850 mm/33,5" | Semi-mobile system    |
| Abrasive disc Ø300 mm/12"               | Material transport    |
| Suction lance Ø76 mm/3"                 | Brick saw Ø400 mm/16" |
| Concrete milling machine                | Cleaning Ø50 mm/2"    |
| Depressed centre disc Ø300 mm/12"       |                       |

## Task or tool

|              |
|--------------|
| Drilling     |
| Demolition   |
| Water damage |

## Task or tool

Jackhammering, wall sanding, concrete grinding, demolition work, kitchen and bathroom renovation, and other construction work

## 1-phase, 1-motor dust extractor

### DC 1800

The DC 1800 and DC 1800XL are high-quality, compact versions of our best-selling DC 2900. It combines ease of use with a large suction capacity and high level of filtration.

### DC 2900

A small, lightweight dust extractor that can handle tough conditions. Equipped with a cyclone inlet, reverse pulse filter cleaning and separate HEPA filter.

## 1-phase, twin-motor dust extractor

**DC 3900**, powerful, can handle tough jobs and is easy to transport.

**DC Tromb 400**, compact, powerful, robust and efficient.

**DC 3900 Twin**, integrated pre-separator, the floor finishers' favourite, handles large quantities of dust.

## 3-phase dust extractor

**DC Storm 500 (4kW), 600 (10hp) and 700 (7.5kW)**. DC Storm is compact, simple to transport and powerful. All models feature a direct-driven, three-phase turbo pump suitable for continuous operation, heavy material transport, source extraction and cleaning. The models equipped with frequency converters are suitable for use when only 16A access is available.

### DC 5900 9.2kW, 9.2kWS and 15 hp.

DC 5900 S model provides powerful suction for use with long hoses. The DC 5900 P model provides airflow for several users at the same time.

## Wet-vac

### DC 50W and DC 75W

Sucks up water and slurry in all situations, for example when making holes with a diamond saw. The slurry can be collected in a filter bag. The unit is equipped with a submersible pump for continuous evacuation of the water.

## Air cleaner

### DC AirCube 500, DC AirCube 1200 and DC AirCube 2000

Cleans the air in the workplace. Air cleaners are used as a complement to source extraction in very dusty environments.

Recommended air change is 10 times per hour minimum.



When large quantities of dust are produced, we recommend a pre-separator



DCF 2800



DCF 60



DC 1800



DC 1800 XL



DC 2900c



DCF 3900



DC 3900c



DC Tromb 400L



DC 3900c Twin



DCF Storm



DCF Wheelbarrow



DC Storm 600L



DC 5900c



DC Storm LPG



DC 50W



DC 75W

### Dust Classification H



The filter systems in all Dustcontrol dust extractors are built to comply with the stringent IEC machine classification H.



DC AirCube 500



DC AirCube 1200



DC AirCube 2000





**MINI**





# DC 1800

Light and easy to use

This machine is particularly suitable for general cleaning and source extraction from handheld power tools (with suction casings up to Ø125 mm /5") and small table saws.

The DC 1800 is equipped with a container. A plastic bag can be used with the bag holder inside the container to facilitate the emptying of dust and other material.

## Part No DC 1800 50/60 Hz

|        |                             |
|--------|-----------------------------|
| 101800 | 230V /50 Hz                 |
| 101801 | 230V /50 Hz Auto start, EU» |
| 101808 | 230V /50 Hz CH              |
| 101810 | 115V /50 Hz UK              |
| 101820 | 230V /50 Hz UK              |
| 101830 | 115V /60 Hz UL              |



## Supplied with (Part No)

Suction hose (Ø38 mm /1.5") 5 m/16 ft (2111)  
 Suction hose antistatic (Ø38 mm /1.5") 5 m/16 ft (2012) UK/UL model  
 Connecting sleeve (2115)  
 Coupling socket (2108)  
 Floor nozzle B370 /W17" (7235)  
 Suction pipe (Ø38 mm /1.5") (7257)  
 Plastic bag (42291)  
 Bag support frame (42369)  
 Fine filter, cellulose (42029)  
 HEPA H13 filter (42027)



## Technical data

|                                 |                            |
|---------------------------------|----------------------------|
| H x W x D (cm/inch)             | 74x38x38 /29"x15"x15"      |
| Weight                          | 14 kg /31 lbs              |
| Container                       | 20 l /5.3 US gal           |
| Flow at open inlet              | 215/205 m³/h / 126/120 cfm |
| Negative pressure, max 115/230V | 21/24 kPa /84/96 inwg      |
| Power consumption 115/230V      | 1340/1285 W                |
| Sound level                     | 66 dB(A)                   |

# DC 1800 XL

Easy to use

The DC 1800 eco XL is a small extraction solution for working with large amounts of dust. The 55 l container gives this unit the capacity to work uninterrupted for longer periods of time.

As this unit is thought to be used for parquet grinding or paired with a floor grinder, it is supplied with an antistatic hose set and does not come with any accessories.

## Part No DC 1800 XL

|        |                             |
|--------|-----------------------------|
| 101880 | 230V /50 Hz EU              |
| 101881 | 230V /50 Hz Auto start*, EU |
| 101884 | 230V /50 Hz UK              |
| 101885 | 115V /60 Hz UL              |
| 101888 | 230V /50 Hz CH              |
| 101886 | 230V /50 Hz Auto start*, UK |



## Supplied with (Part No)

Suction hose antistatic (Ø38 mm) 5 m (2012+2114)  
 Coupling socket 50/38 (2108)  
 Fine filter, cellulose (42029)  
 HEPA H13 filter (42027)



## Technical data

|                                 |                            |
|---------------------------------|----------------------------|
| H x W x D (cm/inch)             | 116x38x38 /46"x15"x15"     |
| Weight                          | 19 kg /42 lbs              |
| Container                       | 55 l /14.3 US gal          |
| Flow at open inlet              | 215/205 m³/h / 126/120 cfm |
| Negative pressure, max 115/230V | 21/24 kPa / 84/96 inwg     |
| Power consumption 115/230V      | 1340/1285 W                |
| Sound level                     | 68 dB(A)                   |

» DC 1800 Autostart. Plug the handheld power tool into the power socket on the unit. Set the selector switch to the AUTO position. The dust extractor will start automatically when the power tool is started.

# DC 2900c

Best-seller

The DC 2900c is our most popular dust extractor. It is suitable for vacuum cleaning and source extraction from handheld power tools (with suction casings up to Ø125 mm /5") and small table saws. The DC 2900c has a sturdy steel chassis with large wheels, but is still light and portable.

## Part No DC 2900c, 50/60 Hz

|        |                             |
|--------|-----------------------------|
| 120000 | 230V /50 Hz                 |
| 120003 | 230V /50 Hz UK              |
| 120008 | 230V /50 Hz CH              |
| 120013 | 115V /50 Hz UK              |
| 120015 | 115V /60 Hz UL              |
| 120100 | 230V /50 Hz Auto start, EU» |
| 120103 | 230V /50 Hz Auto start, UK» |



## Supplied with (Part No)

Suction hose (Ø38 mm/1.5") 5 m /16 ft (2111)  
 Suction hose antistatic (Ø38 mm /1.5") 5 m/16 ft (2012) UK/US/CAN model  
 Connecting sleeve (2115)  
 Coupling socket (2108)  
 Floor nozzle B370 mm /W17" (7235)  
 Suction pipe Ø38 mm /1.5" (7257)  
 Plastic bag (42702)  
 Fine filter, cellulose (42029)  
 HEPA H13 filter (42027)



## Technical data

|                                 |                           |
|---------------------------------|---------------------------|
| H x W x D (cm/inch)             | 111x44x55 /43"x17"x21"    |
| Weight                          | 16 kg /35 lbs             |
| Collector                       | 20 l /5.3 US gal          |
| Flow at open inlet              | 215/205 m³/h /126/120 cfm |
| Negative pressure, max 115/230V | 21/24 kPa /84/96 inwg     |
| Power consumption 115/230V      | 1340/1285 W               |
| Sound level                     | 68 dB(A)                  |

# DC 2900a

Best-seller

Collection in a container makes the DC 2900a ideal to use for sharp material such as metal chips.

## Part No DC 2900a, 50/60 Hz

|        |                         |
|--------|-------------------------|
| 121000 | 230V /50 Hz             |
| 121003 | 230V /50 Hz UK          |
| 121008 | 230V /50 Hz CH          |
| 121013 | 115V /50 Hz UK          |
| 121015 | 115V /60 Hz UL          |
| 121100 | 230V /50 Hz Auto start» |

» DC 2900 Autostart. Plug the handheld power tool into the power socket on the unit. Set the selector switch to the AUTO position. The dust extractor will start automatically when the power tool is started.



## Supplied with (Part No)

Suction hose (Ø38 mm/1.5"), 5 m /16 ft, antistatic (2012)  
 Floor nozzle B370 mm /W17" (7235)  
 Suction pipe Ø38 mm/1.5" (7257)  
 Fine filter, polyester (42028)  
 HEPA H13 filter (42027)



## Technical data

|                                 |                            |
|---------------------------------|----------------------------|
| H x W x D (cm/inch)             | 111x44x55 /43"x17"x21"     |
| Weight                          | 19 kg /42 lbs              |
| Container                       | 40 l /10.56 US gal         |
| Flow at open inlet              | 215/205 m³/h / 126/120 cfm |
| Negative pressure, max 115/230V | 21/24 kPa /84/96 inwg      |
| Power consumption 115/230V      | 1340/1285 W                |
| Sound level                     | 68 dB(A)                   |

# DC 1800 H Asbestos

## Safe asbestos removal



The DC 1800 H Asbestos complies with the most stringent requirements and is IFA\* certified. Asbestos is a known cancer causing material that should be removed with caution.

The dust extractor is equipped with an antistatic hose, a plug for the cyclone inlet, plastic bags and other safety features.

Don't take risks with your health when removing asbestos!



### Supplied with (Part No)

- Suction hose antistatic (Ø38 mm /1.5"), 5 m /16 ft (2012)
- Coupling socket (2108)
- Floor nozzle B370 mm /W17" (7235)
- Suction pipe Ø38 mm /1.5" (7257)
- 10 x plastic bags (42285)
- Bag support frame (42369)
- Fine filter, polyester (42028)
- HEPA H13 filter (42027)



### Technical data

|                                 |                       |
|---------------------------------|-----------------------|
| H x W x D (cm/inch)             | 74x38x38 /29"x15"x15" |
| Weight                          | 14 kg/31 lbs          |
| Container                       | 20 l/5.3 US gal       |
| Flow at open inlet              | 205 m³/h /126 cfm     |
| Negative pressure, max 115/230V | 21/24 kPa /96 inwg    |
| Power consumption 115/230V      | 1340/1285 W           |
| Sound level                     | 68 dB(A)              |

| Part No  | DC 1800H Asbestos 50 Hz |
|----------|-------------------------|
| 101800-1 | EU 230V                 |
| 101808-1 | CH 230V                 |
| 101810-1 | UK 115V                 |



\*Institute for occupational safety and health of the German Social Accident Insurance.



# DC 2800 H Asbestos

## Safe asbestos removal



The DC 2800 H Asbestos complies with the most stringent requirements and is IFA\* certified. Asbestos is a known cancer causing material that should be removed with caution.

The dust extractor is equipped with an antistatic hose, a plug for the cyclone inlet, plastic bags and other safety features.

Don't take risks with your health when removing asbestos!



### Supplied with (Part No)

Connecting sleeve (2114)  
Coupling socket (2108)  
Suction hose antistatic (Ø38 mm /1.5") 5 m /16 ft,(2012)  
Floor nozzle B370 mm /W17" (7235)  
Suction pipe (Ø38 mm /1.5") (7257)  
5 x plastic bags (42285)  
Filter pad & Air filter (432183)  
Fine filter, polyester (42028)  
HEPA H13 filter (42027)



### Technical data

|                                 |                        |
|---------------------------------|------------------------|
| H x W x D (cm/inch)             | 111x44x55 /43"x17"x21" |
| Weight                          | 19 kg/42 lbs           |
| Container                       | 40 l/10.6 US gal       |
| Flow at open inlet              | 205 m³/h /126 cfm      |
| Negative pressure, max 115/230V | 21/24 kPa /84/96 inwg  |
| Power consumption 115/230V      | 1340/1285 W            |
| Sound level                     | 70 dB(A)               |

#### Part No DC 2800H Asbestos 50 Hz

121000-2 230V EU  
121013-1 115V UK  
121003-1 230V UK

\*Institute for occupational safety and health of the German Social Accident Insurance.





# MIDI

# DC Tromb 400 H Asbestos

## Safe asbestos removal

1-phase



The DC Tromb 400 H Asbestos is our most powerful 1-phase dust extractor up to now. It is designed to cope with both the demands for a clean and healthy working environment and handheld power tools which are more effective than ever. The dust extractor also enables the user to work without unnecessary interruptions – it tackles up to 400 m³/h.

The DC Tromb is not just powerful, robust and effective but also versatile and all-round. It can handle all kinds of fine dusts and materials created on a construction site created from cutting concrete, sanding, grinding or drilling floors or walls as well as dust from many other industrial factory processes. The machine can be connected to floor grinders and handheld tools like cutting machines, chisel hammers and saws. Due to its compact design the DC Tromb is also easy to move and transport.

As a standard the machine is equipped with a patented self-cleaning filter (washable polyester) and a H13-filter built to be Application Class H. A signal lamp shows when it's time to clean the filter.\*

\* Switch operated reverse pulse filter cleaning.



### Supplied with (Part No)

Connecting sleeve (2129)  
Coupling socket (2008)  
Suction hose antistatic (Ø50 mm /2") 5 m/16 ft (2013)  
Floor nozzle B500 mm /W19,7" (7238)  
Suction pipe (Ø50 mm /2" ) (7265)  
Fine filter, polyester (44017)  
HEPA H13 filter (44016)



### Technical data

|                                   |                       |
|-----------------------------------|-----------------------|
| H x W x D (cm/inch)               | 139x56x70/55"x22"x27" |
| Weight                            | 50 kg/110 lbs         |
| Collection container              | 40 l/10.6 US gal      |
| Flow at open inlet                | 393 m³/h /231 cfm     |
| Negative pressure, max<br>230V EU | 21/24 kPa /88 inwg    |
| Power consumption<br>230V EU      | 3000W                 |
| Sound level                       | 70 dB(A)              |

#### Part No DC Tromb 400 H Asbestos 50 Hz

165000 230V EU  
165008 230V CH



\*Institute for occupational safety and health of the German Social Accident Insurance



# DC 3900

Environmentally friendly



The DC 3900 has a robust, adjustable chassis that makes it easy to transport. The cyclone can be set to two different heights to facilitate the use of a container when necessary. This dust extractor is suitable for cleaning and handheld power tools with suction casings up to 9" such as wall sanders, jackhammers, and saws. Thanks to the tall cyclone, the filters and the powerful motor unit, it can handle large quantities of debris.

## Part No DC 3900a 50/60Hz

|        |                    |
|--------|--------------------|
| 132000 | 230V EU            |
| 132004 | 115V UK            |
| 132003 | 230V UK            |
| 132008 | 230V CH            |
| 132001 | 115V /60 Hz US/CAN |

## Part No DC 3900c 50/60Hz

|        |                     |
|--------|---------------------|
| 131500 | 230V EU             |
| 131501 | 115V UK             |
| 131503 | 230V UK             |
| 131508 | 230V CH             |
| 131502 | 115 V /60 Hz US/CAN |



**Part No DC 3900L 50/60Hz**

131530 230V EU  
 131534 115V UK  
 131533 230V UK  
 131538 230V CH  
 131532 115 V/60 Hz, US/CAN

**Supplied with** (Part No)

Connecting sleeve (2129)  
 Coupling socket (2107)  
 Floor nozzle B500 mm /W19,7" (7238)  
 Suction pipe (Ø50 mm /2") (7265)  
 Fine filter, polyester (42025)  
 HEPA H13 filter (42024)

**a**

Suction hose (Ø50 mm /2"), antistatic, 5 m/16 ft (2013)  
 Container 40 l/10.5 US gal (40070)

**c & L**

Suction hose (Ø50 mm /2"), 5m/16 ft (2401)  
 Suction hose antistatic (Ø50 mm /2") 5 m/16 ft  
 (2013) UK/US/CAN model  
 c: 10 x plastic bags (43619)  
 L: Longopac 22 m /72 ft (432177)

**Technical data**

|                                 |   |
|---------------------------------|---|
| H x W x D (cm/inch)             | 145x60x70 /57"x23"x27"                          |
| Weight                          | 38/35/37 kg /84/77/81 lbs                       |
| Collection                      | 40/20 l/longopac /<br>10.56/5.3 US gal/longopac |
| Flow at open inlet 115/230V     | 320/360/350 m³/h /188 cfm                       |
| Negative pressure, max 115/230V | 20/22 kPa / 80/84 inwg                          |
| Power consumption 115/230V      | 2100/2700/2600 W                                |
| Sound level                     | 70 dB(A)  |









A photograph of a long, empty industrial corridor. On the left side, there is a series of windows or openings in a wall, some of which are covered with white panels. The floor is a smooth, light-colored concrete. The corridor extends into the distance, where a small pile of debris or materials is visible on the right side. The lighting is bright, coming from the windows on the left.

## Capture dust with source extraction.

All dust on construction sites is a health hazard in the long term. However, there are some types of dust that are hazardous in the short term too. It has become standard practice for modern construction companies to take the health of their employees seriously and to minimise the levels of dust in the workplace.

Source extraction means that the dust is captured before it spreads and before it can be breathed in. Dust levels can be significantly reduced by fitting all power tools with suction casings and connecting these to efficient dust extractors.

Cleaning should be carried out with a dust extractor with the classification H. The dust extractor should be equipped with a HEPA filter to prevent the spread of the finest dust particles. Sweeping simply stirs the hazardous dust up into the air, subjecting those in the area to further exposure. To put it simply, source extraction and cleaning using approved dust extractors are absolutely vital.

# DC 3900L Twin DC 3900c Twin

Integrated pre-separators



The DC 3900L Twin eco is a portable and very powerful dust extractor for large quantities of dust. Thanks to its integrated pre-separator, the user can work for long periods without any disruption. It is particularly suitable for heavy concrete grinding, as 80-90% of the coarse material is separated in the pre-separator. The rest of the dust goes into the filter cyclone. It is powerful enough for most applications and is easy to transport. The air flow capacity is suitable for floor grinding machines with diamond discs up to 20" (approx. 500 mm) in diameter.



## Supplied with (Part No)

Connecting sleeve (2129)  
Coupling socket (2107)  
Suction hose antistatic (Ø50 mm /2") 7.5 m/ 22 ft (2013)  
Floor nozzle B500 mm /W 19.7" (7238)  
Suction pipe (Ø50 mm /2") (7265)  
Longopac 22 m /72 ft (432177) /  
10 x plastic bags (43619)  
Fine filter, polyester (42025)  
HEPA H13 filter (42024)



## Technical data

|                                 |                                     |
|---------------------------------|-------------------------------------|
| H x W x D (cm/inch)             | 140x65x97 /55"x25"x38"              |
| Weight                          | 58/54 kg /128/119 lbs               |
| Collection                      | L) Longopac<br>c) 40 l /10.6 US gal |
| Flow at open inlet 115/230V     | 320/360/350 m³/h<br>188 cfm         |
| Negative pressure, max 115/230V | 21/25 kPa /84/100 inwg              |
| Power consumption 115/230V      | 2100/2700/2600 W                    |
| Sound level                     | 70 dB(A)                            |



### Part No DC 3900L Twin eco

132530 230V /50 Hz EU  
132534 115V /50 Hz UK  
132532 115V /60 Hz US/CAN

### Part No DC 3900c Twin eco

132500 230V /50 Hz EU  
132501 115V /50 Hz UK  
132503 230V /50 Hz UK  
132502 115V /60 Hz US/CAN

## DC 3900c Turbo

The professionals' choice

3-phase



The DC 3900c Turbo is a medium-sized dust extractor with a tall cyclone and a three-phase motor that enables it to handle large quantities of debris.

This dust extractor is suitable for long hoses (up to 20 m /65 ft), heavy cleaning (38 mm /1.5" accessories) and for source extraction from power tools such as grinders, hammers and saws. Suitable casings are those for sanding, grinding and diamond discs up to 9" (230 mm) as well as rubber bellows for chisel hammers, drills and jackhammers (part no 6078 & 6130).

### Part No DC 3900c Turbo

133000 400V /50 Hz EU  
133002 460V /60 Hz US/CAN  
133007 575V /50 Hz CAN

### Part No DC 3900a Turbo

133100 400V /50 Hz EU



### Supplied with (Part No)

Suction hose set, 7 m /23 ft, 5 m /16 ft (Ø50 mm /2") and 2 m /6.5 ft (Ø38 mm /1.5"), (2125)  
Floor nozzle B450 mm (7236)  
Suction pipe (Ø50 mm /2") (7257)  
10 x plastic bags (43619)  
Fine filter, polyester (42025)  
HEPA H13 filter (42024)

### Technical data

|                     |                        |
|---------------------|------------------------|
| H x W x D (cm/inch) | 145x60x97 /57"x23"x38" |
| Weight              | 62 kg/137 lbs          |
| Collector           | 20 l/5.3 US gal        |
| Flow at open inlet  | 260 m³/h /153 cfm      |
| Negative pressure   | 30 kPa/120 inwg        |
| Power consumption   | 2200 W/4 hp            |
| Sound level         | 75 dB(A)               |

## DC 3900c Twin Turbo

Continuous operation

3-phase



The DC 3900c Twin Turbo is a very powerful dust extractor that can handle large quantities of dust thanks to its integrated pre-separator. The 3-phase pump allows continuous operation and the possibility of using longer hoses (up to 20 m /65 ft) as the machine generates a high pressure. 80-90% of the coarse material is separated in the pre-separator and the rest of the dust goes into the filter cyclone where it is taken care of.

### Part No DC 3900c Twin Turbo

133200 400V /50 Hz EU  
133002 460V /60 Hz US/CAN  
133207 575V /60 Hz CAN



### Supplied with (Part No)

Connecting sleeve (2129)  
Coupling socket (2107)  
Suction hose antistatic (Ø50 mm /2") 7.5 m /22 ft (2013)  
Floor nozzle B500 mm /W 19.7" (7238)  
Suction pipe Ø50 mm /2" (7265)  
10 x plastic bags (43619)  
Fine filter, polyester (42025)  
HEPA H13 filter (42024)

### Technical data

|                     |                              |
|---------------------|------------------------------|
| H x W x D (cm/inch) | 140x65x97 /55"x25"x38"       |
| Weight              | 81 kg/178 lbs                |
| Collector           | Plastic bag 40 l/10.6 US gal |
| Flow at open inlet  | 260 m³/h /153 cfm            |
| Negative pressure   | 30 kPa /120 inwg             |
| Power consumption   | 2200 W /4 hp                 |
| Sound level         | 75 dB(A)                     |



# Single-Phase Dust Extractors

## DC Tromb



Dustcontrol has taken the DC Tromb to a new level. There are now three new versions within the Tromb family: DC Tromb 400 dust extractor, DCF Tromb pre-separator and a DC TrombTwin dust extractor and pre-separator in one.

As always, we are focusing to meet modern safety requirements along with an ergonomic and modular function. One of the major updates is that the new DC TrombTwin model is separable. The

dust extractor and pre-separator are easily detached and re-assembled from each other making transport simple.

Other important updates include a simpler filter change system and a motor package that is easier to remove. As well as that, improved motors and a sturdier chassis mean that the whole range has gone through a major expansion and upgrade.

### DC Tromb 400



#### Technical data

|  |  |
|--|--|
| H x W x D [cm/inch]                        | 136x60x78/54x24x31                     |
| Weight [kg/lbs]                            | A) 51/112<br>C) 46/101<br>L) 50/110    |
| Inlet Ø [mm/inch]                          | 76/3                                   |
| Collection container [l/gal]               | A) 40/10.6<br>C) 20/5.3<br>L) Longopac |
| Flow at open inlet 115/230V [m³/h/cfm]     | 330/ 393 & 231/ 194                    |
| Max flow 115/230V [m³/h/cfm]               | 360/ 420 & 247/ 212                    |
| Negative pressure, max 115/230V [kPa/inwg] | 20/22/ 84/100                          |
| Power consumption 115/230V [W]             | 2100/2680/3000                         |
| Sound level [dB(A)]                        | 70                                     |



#### Supplied with (Part No)

Connecting sleeve (2129)  
Coupling socket (2008)  
Suction hose antistatic (Ø50 mm /2") 5 m/16 ft (2013)  
Suction hose (Ø50 mm /2") 5 m /16 ft (2401) for model 171500 and 171508  
Floor nozzle B500 mm /W 19.7" (7238)  
Suction pipe (Ø50 mm /2") (7265)  
Fine filter, polyester (44017)  
HEPA H13 filter (44016)

#### Discharge

A) 40 l /10.6 US gal container (40070)  
C) 10 x plastic bags (43619)  
L) Longopac 25 m /82 ft (432177)

### DC Tromb Twin



#### Technical data

|  |                          |
|--|--------------------------|
| H x W x D [cm/inch]                        | 136x60x128/54x24x31      |
| Weight [kg/lbs]                            | CC) 71/156<br>CL) 75/165 |
| Inlet Ø [mm/inch]                          | 76/3                     |
| Collection container [l/gal]               | C) 20/5.3<br>L) Longopac |
| Flow at open inlet 115/230V [m³/h/cfm]     | 330/ 365 & 215/ 194      |
| Max flow 115/230V [m³/h/cfm]               | 360/ 420 & 247/ 212      |
| Negative pressure, max 115/230V [kPa/inwg] | 20/20 /84/100            |
| Power consumption 115/230V [W]             | 2100/2680/3000           |
| Sound level [dB(A)]                        | 70                       |

### DCF Tromb



#### Technical data

|                              |                          |
|------------------------------|--------------------------|
| H x W x D [cm/inch]          | 129x60x78/51x24x31       |
| Weight [kg/lbs]              | L) 32/70<br>C) 27/59     |
| Inlet Ø [mm/inch]            | 76/3                     |
| Collection container [l/gal] | C) 20/5.3<br>L) Longopac |
| Sound level [dB(A)]          | 70                       |



DC Tromb 400



DCF Tromb



| Part no | Description                         |
|---------|-------------------------------------|
| 171500  | DC TROMB 400 C 230V 3000 W EU       |
| 171501  | DC TROMB 400 C 115V UK              |
| 171502  | DC TROMB 400 C 115V USA             |
| 171503  | DC TROMB 400 C 2600 W 230 UK        |
| 171507  | DC TROMB 400 C 115V CAN             |
| 171508  | DC TROMB 400 C 230V 3000 W CH       |
| 171530  | DC TROMB 400 L 230V 3000 W EU       |
| 171531  | DC TROMB 400 L 115V UK              |
| 171532  | DC TROMB 400 L 115V USA             |
| 171533  | DC TROMB 400 L 230V 2600 W UK       |
| 171537  | DC TROMB 400 L 115V CAN             |
| 171538  | DC TROMB 400 L 230V 3000 W CH       |
| 172000  | DC TROMB 400 A 230V 3000 W EU       |
| 172001  | DC TROMB 400 A 115V UK              |
| 172002  | DC TROMB 400 A 115V USA             |
| 172003  | DC TROMB 400 A 230V 2600 W UK       |
| 172008  | DC TROMB 400 A 230V 3000 W CH       |
| 172500  | DC TROMB 400 CC TWIN 230V 3000 W EU |
| 172530  | DC TROMB 400 CL TWIN 230V 3000 W EU |
| 172531  | DC TROMB 400 CL TWIN 115V UK        |
| 172532  | DC TROMB 400 CL TWIN 115V USA       |
| 172537  | DC TROMB 400 CL TWIN 115V CAN       |
| 172538  | DC TROMB 400 L TWIN 230V 3000 W CH  |
| 707000  | DCF TROMB L                         |
| 707001  | DCF TROMB C                         |

# DC 3800 Wood Shavings Extractor

The professionals' choice



The DC 3800 Wood Shavings Extractor is designed especially to be connected to the Gjerde saw. It is suitable for source extraction on most saws and where high degree of separation is required. The DC 3800 Wood Shavings Extractor is a robust, mobile machine that is easy to move around.

As with all of Dustcontrol's mobile dust extractors, the DC Wood Shavings Extractor is very easy to service. The motor package comes from the DC 3900 and the cyclone comes from the DC 2900.

## Part No

|        |   |
|--------|---|
| 118400 | DC 3800 Wood Shavings Extractor, 230V /50 Hz EU |
| 2173   | Hose set for Gjerde saw                         |



## Supplied with (Part No)

Connecting sleeve (2129)  
Suction hose antistatic (Ø50 mm /2") 7.5 m / 22 ft (2013)  
Floor nozzle B500 mm /W 19.7" (7238)  
Suction pipe (Ø50 mm /2") (7265)  
Plastic bags (4714)  
Fine filter, polyester (42025)  
HEPA H13 filter (42024)



## Technical data

|                     |                        |
|---------------------|------------------------|
| H x W x D (cm/inch) | 138x60x70 /54"x23"x27" |
| Weight              | 37 kg /81 lbs          |
| Container           | 90 l /23 US gal        |
| Flow at open inlet  | 320 m³/h /188 cfm      |
| Negative pressure   | 24 kPa /96 inwg        |
| Power consumption   | 2600 W                 |
| Sound level         | 70 dB(A)               |

# DC 4000 PCB

Double filter cyclone



The DC 4000 PCB has been developed to comply with the requirements relating to PCB decontamination and is especially suitable for companies that deal with large volumes of light dust. The machine removes dust effectively and significantly minimises the spread of PCBs, for example when removing sealants. The DC 4000 PCB is a powerful dust extractor that is easy to move around.

It has an air flow of approximately 400 m³/h / 212 cfm and is equipped with double HEPA H13 and double fine filters. The DC 4000 PCB satisfies the Swedish Demolition and Remediation Contractors' recommendations regarding PCB remediation.

## Part No

|        |                            |
|--------|----------------------------|
| 113800 | DC 400 PCB, 230V /50 Hz EU |
|--------|----------------------------|



## Supplied with (Part No)

Connecting sleeve (2129)  
Coupling socket (2107)  
Suction hose antistatic (Ø50 mm /2") 5 m /16 ft (2013)  
Suction hose (Ø76 mm /3") 5 m /16 ft (2001)  
Floor nozzle B500 mm /W 19.7" (7238)  
Suction pipe (Ø50 mm /2") (7265)  
Plastic bags (413619)  
2 x Fine filter, polyester (42025)  
2 x HEPA H13 filter (42024)



## Technical data

|                     |                        |
|---------------------|------------------------|
| H x W x D (cm/inch) | 145x65x70 /60"x25"x27" |
| Weight              | 57 kg /125 lbs         |
| Collector           | 40 l /10.5 US gal      |
| Flow at open inlet  | 400 m³/h /235 cfm      |
| Negative pressure   | 24 kPa /96 inwg        |
| Power consumption   | 2800 W                 |
| Sound level         | 70 dB(A)               |





# MAKI



Dustcontrol  
STORM

Dustcontrol art no 4613



# A force to be reckoned with

## Speedy on-site working

Once on site, The DC Storm is just as simple to manoeuvre – even into previously hard-to-access locations. Quickly roll it to where it's needed, connect it to floor grinders, cutting tools, chisel hammers or saws, get the job done and move on.

## Fitted with HEPA H13 filter

Furthermore, The DC Storm is equipped with a fine filter which separates most of the dust. Then in order to capture close to 100% of the finest and most dangerous particles, DC Storm extractors are fitted with HEPA H13 filters.

The high-efficiency filters have a long service life, which not only results in cleaner air, but also low filter costs.

## H-Classified



The filter systems in all Dustcontrol dust extractors are built to comply with the the stringent IEC machine classification H. This means that all Dustcontrol extractors – comply with regulations governing environments that generate hazardous dust, like silica and asbestos.



# New Compact DC Storm

## Simple to transport, easy to use dust extractor

- + H-Classified. Approved for use with hazardous dust
- + Equipped with HEPA H13 filter
- + Upright transport in regular-sized vans and trailers
- + Connects to floor grinders, cutting tools, chisel hammers or saws
- + Powerful high-capacity dust extraction
- + Robust design for tough conditions and long working life

## Compact lightweight design

Building on the same well-proven principles as Dustcontrol's powerful DC 5900 extractors, our new direct-drive, three-phase dust extractor now adds one more key worker benefit: A compact lightweight design for quick and easy upright transport in regular-sized vans and trailers. This helps work start on time and avoids costly delays.

Many different models are available. All feature a direct-driven, three-phase turbo pump suitable for continuous operation, heavy material transport, spot extraction and cleaning. The pump also provides sufficient airflow for simultaneous multiple use, e.g. as a central unit in a semi-mobile system. A sturdy steel chassis maximises durability.

Three basic models are available: bag (c), container (a) and Longopac (L) , each powered by a 4 kW, 7.5 kW or a 10 hp motor.



# DC Storm

3-phase



## Powerful, reliable and safe mobile dust extraction

The DC Storm is a powerful and reliable mobile dust extractor. They are built on a robust and sturdy steel chassis for maximum durability, for example on construction sites. With a direct-driven, three-phase turbopump, the DC Storm is suitable for continuous operation, conveying heavy material away, source extraction and cleaning.

The DC Storm provides sufficient air flow for several users at the same time and it can also be used as a semi-mobile central unit in a tubing system. It is suitable for source extraction for grinding discs up to approx. 800 mm/ 31" in diameter.

Three basic models are available: bag (c), container (a) and longopac (L), each powered by a 4 kW, 7.5 kW or a 10 hp motor.

DC Storm 700 is also equipped with a frequency converter, very useful when only 16A are available. This machine is equipped with a PTFE filter extracting large quantities of concrete dust and is suitable for example floor grinding.

Info of all our models – DC Storm 500, DC Storm 600 and DC Storm 700 is presented on the following pages.

### Part No DC Storm 500c/a/L

|        |                                  |
|--------|----------------------------------|
| 119400 | DC Storm 500c, 400V /50 Hz /4 kW |
| 119402 | DC Storm 500a, 400V /50 Hz /4 kW |
| 119430 | DC Storm 500L, 400V /50 Hz /4 kW |

### Part No DC Storm 500c/a/L PTFE

|        |  |
|--------|--|
| 119404 | DC Storm 500c PTFE, 400V D/690V Y/4 kW |
| 119406 | DC Storm 500a PTFE, 400V/ 50 Hz /4 kW  |
| 119432 | DC Storm 500L PTFE, 400V / 50 Hz /4 kW |



## DC Storm 500c



### Supplied with (Part No)

Coupling socket (2107)  
Coupling socket (2008)  
Suction hose (Ø50 mm /2") 7.5 m /22 ft (2401)  
Floor nozzle B500 mm /W 19.7" (7238)  
Suction pipe (Ø50 mm /2") (7265)  
10 x plastic bags (46145)  
Fine filter, polyester (44212)  
HEPA H13 filter (42869)



### Technical data

|                     |                         |
|---------------------|-------------------------|
| H x W x D (cm/inch) | 179x78x116 /70"x31"x46" |
| Weight              | 178 kg /392 lbs         |
| Collector           | 60 l /15 US gal         |
| Flow at open inlet  | 500 m³/h /294 cfm       |
| Negative pressure   | 25 kPa                  |
| Power consumption   | 4 kW                    |
| Sound level         | 75 dB(A)                |



## DC Storm 500a



### Supplied with (Part No)

Coupling socket (2107)  
Coupling socket (2008)  
Suction hose antistatic (Ø50 mm /2") 7.5 m/22 ft (2013)  
Floor nozzle B500 mm /W 19.7" (7238)  
Suction pipe (Ø50 mm /2") (7265)  
Container 75 l /20 US gal (7368)  
Fine filter, polyester (44212)  
HEPA H13 filter (42869)



### Technical data

|                     |                         |
|---------------------|-------------------------|
| H x W x D (cm/inch) | 179x78x116 /70"x31"x46" |
| Weight              | 180 kg /397 lbs         |
| Container           | 75 l /19 US gal         |
| Flow at open inlet  | 500 m³/h /294 cfm       |
| Negative pressure   | 25 kPa                  |
| Power consumption   | 4 kW                    |
| Sound level         | 75 dB(A)                |



## DC Storm 500L



### Supplied with (Part No)

Coupling socket (2107)  
Coupling socket (2008)  
Suction hose antistatic (Ø50 mm /2") 5 m/16 ft (2013)  
Floor nozzle B 500 mm /W 19.7" (7238)  
Suction pipe (Ø50 mm /2") (7265)  
Longopac 25 m /82 ft (44077)  
Fine filter, polyester (44212)  
HEPA H13 filter (42869)



### Technical data

|                     |                         |
|---------------------|-------------------------|
| H x W x D (cm/inch) | 179x78x116 /70"x31"x46" |
| Weight              | 178 kg /392 lbs         |
| Collector           | 25 m /82 ft /flexible   |
| Flow at open inlet  | 500 m³/h /294 cfm       |
| Negative pressure   | 25 kPa                  |
| Power consumption   | 4 kW                    |
| Sound level         | 75 dB(A)                |

# DC Storm 600



## DC Storm 600c



### Supplied with (Part No)

Coupling socket (2107)  
Coupling socket (2008)  
Suction hose antistatic (Ø50 mm /2") 7.5 m/22 ft (2013)  
Floor nozzle B500 mm /W 19.7" (7238)  
Suction pipe (Ø50 mm /2") (7265)  
10 x plastic bags (46145)  
Fine filter, polyester (44212)  
HEPA H13 filter (42807)

### Technical data

|                     |                         |
|---------------------|-------------------------|
| H x W x D (cm/inch) | 179x78x116 /70"x31"x46" |
| Weight              | 201 kg /442 lbs         |
| Collector           | 60 l /16 US gal         |
| Flow at open inlet  | 600 m³/h /353 cfm       |
| Negative pressure   | 24 kPa /96 inwg         |
| Power consumption   | 10 HP                   |
| Sound level         | 75 dB(A)                |

## DC Storm 600a



### Supplied with (Part No)

Coupling socket (2107)  
Coupling socket (2008)  
Suction hose antistatic (Ø50 mm /2") 7.5 m/22 ft (2013)  
Floor nozzle B500 mm /W 19.7" (7238)  
Suction pipe (Ø50 mm /2") (7265)  
Container 75 l /20 US gal (7368)  
Fine filter, polyester (44212)  
HEPA H13 filter (42807)

### Technical data

|                     |                         |
|---------------------|-------------------------|
| H x W x D (cm/inch) | 179x78x116 /70"x31"x46" |
| Weight              | 203 kg /447 lbs         |
| Container           | 75 l /20 US gal         |
| Flow at open inlet  | 600 m³/h /353 cfm       |
| Negative pressure   | 24 kPa /96 inwg         |
| Power consumption   | 10 HP                   |
| Sound level         | 75 dB(A)                |

## DC Storm 600L PTFE



### Supplied with (Part No)

Coupling socket (2107)  
Coupling socket (2008)  
Suction hose antistatic (Ø50 mm /2") 7.5 m/22 ft (2013)  
Floor nozzle B500 mm /W 19.7" (7238)  
Suction pipe (Ø50 mm /2") (7265)  
Longpac 25 m /82 ft (44077)  
Fine filter, PTFE (44081)  
HEPA H13 filter (42807)

### Technical data

|                     |                         |
|---------------------|-------------------------|
| H x W x D (cm/inch) | 179x78x116 /70"x31"x46" |
| Weight              | 201 kg /442 lbs         |
| Collector           | 20 m /65 ft /flexible   |
| Flow at open inlet  | 600 m³/h /353 cfm       |
| Negative pressure   | 24 kPa /96 inwg         |
| Power consumption   | 10 HP                   |
| Sound level         | 75 dB(A)                |

#### Part No DC Storm 600c

119407 460V/ 60 Hz /10hp US  
119436 220/380V 60 Hz /10hp US  
119408 600V 60 Hz /10hp CAN

#### Part No DC Storm 600a

119409 460V /60 Hz /10hp US  
119437 220/380V 60 Hz /10hp US  
119410 600V/ 60 Hz /10hp CAN

#### Part No DC Storm 600L PTFE

119434 460V 60 Hz /10hp US  
119435 220/380V 60 Hz /10hp US



# DC Storm 700

3-phase



## DC Storm 700c



### Supplied with (Part No)

Coupling socket (2107)  
Coupling socket (2008)  
Suction hose (Ø50 mm /2") 7.5 m/ 22 ft (2401)  
Floor nozzle B500 mm /W 19.7" (7238)  
Suction pipe (Ø50 mm /2") (7265)  
10 x plastic bags (46145)  
Fine filter, polyester (44212)  
HEPA H13 filter (42807)

### Technical data

|                     |                         |
|---------------------|-------------------------|
| H x W x D (cm/inch) | 179x78x116 /70"x31"x46" |
| Weight              | 210 kg /463 lbs         |
| Collector           | 60 l /16 US gal         |
| Flow at open inlet  | 700 m³/h /412 cfm       |
| Negative pressure   | 22 kPa /88 inwg         |
| Power consumption   | 7.5 kW                  |
| Sound level         | 75 dB(A)                |



## DC Storm 700a



### Supplied with (Part No)

Coupling socket (2107)  
Coupling socket (2008)  
Suction hose antistatic (Ø50 mm /2") 7.5 m/ 22 ft (2013)  
Floor nozzle B500 mm /W 19.7" (7238)  
Suction pipe (Ø50 mm /2") (7265)  
Container 75 l /20 US gal (7368)  
Fine filter, polyester (44212)  
HEPA H13 filter (42807)

### Technical data

|                     |                         |
|---------------------|-------------------------|
| H x W x D (cm/inch) | 179x78x116 /70"x31"x46" |
| Weight              | 214 kg /472 lbs         |
| Container           | 75 l /20 US gal         |
| Flow at open inlet  | 700 m³/h /412 cfm       |
| Negative pressure   | 22 kPa /88 inwg         |
| Power consumption   | 7.5 kW                  |
| Sound level         | 75 dB(A)                |



## DC Storm 700L PTFE



### Supplied with (Part No)

Coupling socket (2107)  
Coupling socket (2008)  
Suction hose antistatic (Ø50 mm /2") 7.5 m/22 ft (2013)  
Floor nozzle B500 mm /W 19.7" (7238)  
Suction pipe (Ø50 mm /2") (7265)  
Longopac 25 m /82 ft (44077)  
Fine filter, PTFE (44081)  
HEPA H13 filter (42807)

### Technical data

|                     |                         |
|---------------------|-------------------------|
| H x W x D (cm/inch) | 179x78x116 /70"x31"x46" |
| Weight              | 212 kg /467 lbs         |
| Collector           | Longopac/flexible       |
| Flow at open inlet  | 700 m³/h /412 cfm       |
| Negative pressure   | 22 kPa /88 inwg         |
| Power consumption   | 7.5 kW                  |
| Sound level         | 75 dB(A)                |

#### Part No DC Storm 700c/a

119403 DC Storm 700c, 400V /50 Hz VFD  
119418 DC Storm 700a, 400V /50 Hz VFD

#### Part No DC Storm 700L PTFE

119419 400V /50 Hz /7.5 kW VFD

All DC Storm 700 is also equipped with a frequency converter, very useful when only 16A are available. This machine is equipped with a PTFE filter extracting large quantities of concrete dust and is suitable for example floor grinding.



## DC 5900 9.2kW S

For heavy material waste

3-phase



The machine is primarily intended to be used for pneumatic conveying or the removal of very heavy material in conjunction with a pre-separator. The extra-large suction capacity can also be utilised for regular source extraction and cleaning, in situations where extra long hoses up to 50 m are required. To prevent overheating during intensive use, the pump has been equipped with a cold air intake.

The reverse pulse filter cleaning system provides extra-long filter life and ensures no loss of suction.



### Supplied with (Part No)

Fine filter, polyester (429204)  
HEPA H13 filter (42807)



### Technical data

|                     |                           |
|---------------------|---------------------------|
| H x W x D (cm/inch) | 194x78x116 / 76"x30"x45"  |
| Weight              | 200 kg / 440 lbs          |
| Collector           | Container 75 l / bag 60 l |
| Flow at open inlet  | 500 m³/h / 294 cfm        |
| Negative pressure   | 40 kPa / 160 inwg         |
| Power consumption   | 9.2 kW / 15 hp            |
| Sound level         | 75 dB(A)                  |

**Part No DC 5900 9.2 kW S/ 400V / 50 Hz**

119341 400V / 50 Hz 75 l container  
119340 400V / 50 Hz 60 l bag

# DC 5900 9.2kW P

Maximum power

The DC 5900c 9.2 kW P generates an extremely large airflow and is therefore optimised for many extraction points. It is generally used in semi-mobile extraction systems where the machine is conveniently positioned in a central location and connected to a tubing system. Maximum efficiency is achieved and maintained with up to four simultaneous users.

## Part no DC 5900 9.2kW 400V/50 Hz

|        |                                       |
|--------|---------------------------------------|
| 119305 | 75 l container                        |
| 119301 | 60 l bag                              |
| 119333 | Longopac                              |
| 119336 | 460V /15hp 60Hz longopac US/CAN       |
| 119314 | 460V /15hp 60Hz 60 l bag US/CAN       |
| 119315 | 460V /15hp 60Hz 75 l container US/CAN |
| 119316 | 600V /15hp 60Hz 60 l bag US/CAN       |
| 119317 | 600V /15hp 60Hz 75 l container US/CAN |



3-phase



## Supplied with (Part No)

Discharge:

- a) 75 l /20 US gal container (40070)
- c) 10 x plastic bags (46145)
- L) Longopac 25 m /82 ft (44077)

Fine filter, polyester (4292)

HEPA H13 filter (42807)



## Technical data

|                     |                                    |
|---------------------|------------------------------------|
| H x W x D (cm/inch) | 194x78x116 /76"x30"x45"            |
| Weight              | 210 kg /463 lbs                    |
| Collector           | Container 75 l/ bag 60 l/ longopac |
| Flow at open inlet  | 800 m³/h /471 cfm                  |
| Negative pressure   | 28 kPa /112 inwg                   |
| Power consumption   | 9.2 kW /15hp                       |



# DC 5900H Asbestos

For hazardous environments

3-phase



All DC 5900s are powerful and reliable mobile dust extractors. They are built on a robust and sturdy steel chassis for maximum durability. Now also for work in hazardous environments. The DC 5900 H Asbestos is certified by the IFA\* for asbestos removal. Don't take risks with your health when removing asbestos!



## 4 kW Supplied with (Part No)

- Coupling socket (2107)
- Coupling socket (2008)
- Suction hose antistatic (Ø50 mm /2") 7.5 m /22 ft (2013)
- Floor nozzle B 500mm /W 19.7" (7238)
- Suction pipe (Ø50 mm /2") (7265)
- Fine filter, polyester (4292)
- HEPA H13 filter (42869)
- Container 75 l /19 US gal (7368)

## 9.2 kW P & S Supplied with (Part No)

- Fine filter, polyester, 9.2 kW S (4292)
- Fine filter, polyester, 9.2 kW P (429204)
- HEPA H13 filter (42807)



## Technical data

|                     | 4 kW                    | 9.2 kW P                | 9.2 kW S                |
|---------------------|-------------------------|-------------------------|-------------------------|
| H x W x D (cm/inch) | 194x78x116 /76"x30"x45" | 194x78x116 /76"x30"x45" | 194x78x116 /76"x30"x45" |
| Weight              | 176 kg /388 lbs         | 210 kg /462 lbs         | 210 kg /462 lbs         |
| Collector           | Container 75 l          | Container 75 l          | Container 75 l          |
| Flow at open inlet  | 470 m³/h /353 cfm       | 800 m³/h /471 cfm       | 500 m³/h /294 cfm       |
| Negative pressure   | 28 kPa /112 inwg        | 28 kPa /112 inwg        | 40 kPa /160 inwg        |
| Power consumption   | 4 kW                    | 9.2 kW                  | 9.2 kW                  |
| Sound level         | 75 dB(A)                | 75 dB(A)                | 75 dB(A)                |

## Part No DC 5900H Asbestos 400V /50 Hz

|        |                       |
|--------|-----------------------|
| 119370 | 400V /50 Hz /4 kW     |
| 119350 | 400V /50 Hz /9.2 kW P |
| 119360 | 400V /50 Hz /9.2 kW S |

\*The dust extractor has been DGUV tested and approved by IFA (Institut für Arbeitsschutz der Deutschen Gesetzlichen Unfallversicherung).



# STORM



Portability and High Capacity  
in a Compact Package. DC **STORM** LPG

# Powered by Propane

Clean burning propane and the reliability of Dustcontrol powered by a 21 hp engine. Designed for the user with class leading capacity and minimal maintenance requirements, the unit will operate approximately 8 hours on a full tank and the machine is equipped with an external self-discharging cyclonic air filter with visual filter monitor.

## Packed with Features

- Effective reverse pulse cleaning on the main filter. Extends filter life.
- High efficiency, true cyclonic primary dust separation. Relieves filter loading, minimizes down-time and maximizes up-time.
- H13 HEPA filtration. Filters even the most dangerous respirable particulate and keeps your crew safe.
- Large pneumatic wheels, locking casters and an ergonomic handle. Easily moved and maneuvered.
- Integral chassis fork pockets for ease of loading and movement from place to place.
- Reliable belt drive and automatic mechanical clutch.
- Low maintenance 21 hp motor with standard oil cooler and low oil pressure shut down.
- Three way catalytic muffler, O<sub>2</sub> sensor, auto shut-down and alarm indication.
- Key start and all operator controls in one place.
- Remote battery charger hook up point and LED battery monitor.
- 2 x 18 W LED Work Lamps for when you get into those out of the way places.
- 2 x USB outlets to keep your mobile devices charged.



**Part no DC Storm LPG**  
119900 DC Storm LPGc  
119901 DC Storm LPGL

## DC Storm<sup>®</sup> LPG



### Supplied with (Part No)

C) Intellibag (46145)  
L) Longopac 25 m /82 ft (44077)  
HEPA H13 filter (42807)  
Fine filter, PTFE (44081)



### Technical data

|                         |                              |
|-------------------------|------------------------------|
| H x W x D (cm/inch)     | 180x790x160 /70" x 31" x 63" |
| Weight                  | 375 kg /826 lbs              |
| Tank volume             | 15.4 kg /33½ lbs             |
| Collection container    | 25 m /82 ft /flexible        |
| Flow at open inlet      | 820 m³/h /483 cfm            |
| Negative pressure       | 30 kPa /120 inwg             |
| Engine power (Vanguard) | 21 hp                        |
| Final filtration        | HEPA H13 filter              |
| Sound level             | 79 dB(A)                     |

Alternative material discharge systems are available; metal container or Dustcontrol Intellibag.

# Compare our Dust Extractors

To help you find the right machine, we have compiled the various technical data relating to our dust extractors. Our machines can be compared with each other and against our competitors.



| Technical data mini                 | DC 1800                              | DC 1800XL                            | DC 2900c                             | DC 2900a                             | DC 1800H Asbestos                    | DC 2800H Asbestos                    |
|-------------------------------------|--------------------------------------|--------------------------------------|--------------------------------------|--------------------------------------|--------------------------------------|--------------------------------------|
| H x W x D (cm/inch)                 | 74x38x38 / 29"x15"x15"               | 116x38x38 / 46"x15"x15"              | 111x44x55 / 43"x17"x21"              | 111x44x55 / 43"x17"x21"              | 74x38x38 / 29"x15"x15"               | 111x44x55 / 43"x17"x21"              |
| Weight                              | 14 kg / 31 lbs                       | 19 kg / 42 lbs                       | 16 kg / 35 lbs                       | 19 kg / 42 lbs                       | 14 kg / 22 lbs                       | 19 kg / 42 lbs                       |
| Inlet                               | Ø38 mm / 1.5"                        | Ø38 mm / 1.5"                        | Ø38 mm / 1.5"                        | Ø38 mm / 1.5"                        | Ø38 mm / 1.5"                        | Ø38 mm / 1.5"                        |
| Collection container                | 20 l / 5.3 US gal                    | 55 l / 14.3 US gal                   | 20 l / 5.3 US gal                    | 40 l / 10.6 US gal                   | 20 l / 5.3 US gal                    | 40 l / 10.6 US gal                   |
| Flow at open inlet<br>115/230 v     | 215/205 m³/h / 126/120 cfm           | 215/205 m³/h / 126/120 cfm           | 215/205 m³/h / 126/120 cfm           | 215/205 m³/h / 126/120 cfm           | 215/205 m³/h / 126/120 cfm           | 215/205 m³/h / 126/120 cfm           |
| Negative pressure, max<br>115/230 v | 21/24 kPa / 84/96 inwg               | 21/24 kPa / 84/96 inwg               | 21/24 kPa / 84/96 inwg               | 21/24 kPa / 84/96 inwg               | 21/24 kPa / 96 inwg                  | 21/24 kPa / 84/96 inwg               |
| Power consumption<br>115/230 v      | 1340/1285 W                          | 1340/1285 W                          | 1340/1285 W                          | 1340/1285 W                          | 1285 W                               | 1285 W                               |
| Sound level                         | 66 dB(A)                             | 68 dB(A)                             | 68 dB(A)                             | 68 dB(A)                             | 68 dB(A)                             | 70 dB(A)                             |
| Filter area, fine/HEPA filter       | 1.5 m² / 0.85 m²<br>16 ft² / 9.1 ft² | 1.5 m² / 0.85 m²<br>16 ft² / 9.1 ft² | 1.5 m² / 0.85 m²<br>16 ft² / 9.1 ft² | 1.5 m² / 0.85 m²<br>16 ft² / 9.1 ft² | 1.5 m² / 0.85 m²<br>16 ft² / 9.1 ft² | 1.5 m² / 0.85 m²<br>16 ft² / 9.1 ft² |



| Technical data midi           | DC 3900 a/c/L  | DC 3900 Twin c/L                     | DC Tromb 400 Asbestos                | DC 3800 Wood Shavings Extractor      |
|-------------------------------|--|--------------------------------------|--------------------------------------|--------------------------------------|
| H x W x D (cm/inch)           | 145x60x70 / 57"x23"x27"                                | 140x65x97 / 55"x25"x38"              | 139x56x70 / 55"x22"x27"              | 138x60x70 / 54"x23"x27"              |
| Weight                        | 38/35/37 kg / 84/77/81 lbs                             | 54/58 kg / 119/127 lbs               | 50 kg / 110 lbs                      | 37 kg / 81 lbs                       |
| Inlet                         | Ø50 mm / 2"  | Ø50 mm / 2"                          | Ø50 mm / 2"                          | Ø50 mm / 2"                          |
| Collection container          | 40 l / 20 l / longopac<br>10.6 / 5.3 US gal / longopac | 40 l / 10.6 US gal / longopac        | 40 l / 10.6 US gal                   | 90 l / 24 US gal                     |
| Flow at open inlet            | 320/360/350 m³/h / 188 cfm                             | 320/360/350 m³/h / 188 cfm           | 393 m³/h / 231 cfm                   | 320 m³/h / 188 cfm                   |
| Negative pressure, max        | 21/25 kPa / 84/100 inwg                                | 21/25 kPa / 84/100 inwg              | 21/24 kPa / 88 inwg                  | 24 kPa / 96 inwg                     |
| Power consumption             | 2100/2700/2600 W                                       | 2600 W                               | 3000 W                               | 2600 W                               |
| Sound level                   | 70 dB(A)   | 70 dB(A)                             | 70 dB(A)                             | 70 dB(A)                             |
| Filter area, fine/HEPA filter | 1.8 m² / 1.5 m²<br>19.4 ft² / 16 ft²                   | 1.8 m² / 1.5 m²<br>19.4 ft² / 16 ft² | 1.8 m² / 1.5 m²<br>19.4 ft² / 16 ft² | 1.8 m² / 1.5 m²<br>19.4 ft² / 16 ft² |



| Technical data midi           | DC 4000c PCB                         | DC 3900c Turbo                       | DC 3900c Twin Turbo                  | DC Tromb 400 a/c/L   |
|-------------------------------|--------------------------------------|--------------------------------------|--------------------------------------|--|
| H x W x D (cm/inch)           | 145x65x70 / 60"x25"x27"              | 145x60x97 / 57"x23"x38"              | 140x65x97 / 55"x25"x38"              | 139x56x70 / 54"x22"x27"  |
| Weight                        | 57 kg / 126 lbs                      | 62 kg / 137 lbs                      | 81 kg / 178 lbs                      | a/ 50 kg c/ 46 kg L/ 48 kg<br>a/ 110 lbs c/ 101 lbs L/ 106 lbs |
| Inlet                         | Ø50 mm / 2"                          | Ø50 mm / 2"                          | Ø50 mm / 2"                          | Ø76 mm / 3"  |
| Collection container          | 40 l / 10.6 US gal                   | 20 l / 5.3 US gal                    | 40 l / 10.6 US gal                   | 20 l / 40 l / 5.3 / 10.6 US gal / longopac                     |
| Flow at open inlet            | 400 m³/h / 235 cfm                   | 260 m³/h / 153 cfm                   | 260 m³/h / 153 cfm                   | 330/393 m³/h / 194 cfm   |
| Negative pressure, max        | 24 kPa / 96 inwg                     | 30 kPa / 120 inwg                    | 30 kPa / 120 inwg                    | 21/25 kPa / 84/88 inwg   |
| Power consumption             | 2800 W                               | 2200 W / 4 hp                        | 2200 W / 4 hp                        | 2100/2680/3000 W   |
| Sound level                   | 70 dB(A)                             | 75 dB(A)                             | 75 dB(A)                             | 70 dB(A)   |
| Filter area, fine/HEPA filter | 3.6 m² / 3.0 m²<br>39 ft² / 32.3 ft² | 1.8 m² / 1.5 m²<br>19.4 ft² / 16 ft² | 1.8 m² / 1.5 m²<br>19.4 ft² / 16 ft² | 2.5 m² / 2.2 m²<br>20.4 ft² / 23.6 ft²                         |





| Technical data maxi           | DC STORM 500 a/c/L   | DC STORM 600 a/c/L   | DC STORM 700 a/c/L   | DC 5900 9.2 kW S   | DC 5900 9.2 kW P   |
|-------------------------------|--|--|--|--|--|
| H x W x D (cm/inch)           | 179x78x116 /70"x31"x46"  | 179x78x116 /70"x31"x46"  | 179x78x116 /70"x31"x46"  | 194x78x116 /76"x30"x45"  | 194x78x116 /76"x30"x45"  |
| Weight                        | <b>a)</b> 180 kg /397 lbs<br><b>c, L)</b> 178 kg /392 lbs                          | <b>a)</b> 203 kg /447 lbs <b>c)</b> 201 kg /442 lbs <b>L)</b> 201 kg /442 lbs      | <b>a)</b> 214 kg /472 lbs <b>c)</b> 210 kg /463 lbs <b>L)</b> 212 kg /467 lbs      | 200 kg /441 lbs  | 210 kg /463 lbs  |
| Inlet                         | Ø76 mm /3"   | Ø76 mm /3"   | Ø76 mm /3"   | Ø108 mm /4.2"  | Ø108 mm /4.2"  |
| Collection container          | <b>a)</b> 75 l /20 US gal <b>c)</b> 60 l /16 US gal <b>L)</b> longopac 20 m /65 ft | <b>a)</b> 75 l /20 US gal <b>c)</b> 60 l /16 US gal <b>L)</b> longopac 20 m /65 ft | <b>a)</b> 75 l /20 US gal <b>c)</b> 60 l /16 US gal <b>L)</b> longopac 20 m /65 ft | <b>a)</b> 75 l /20 US gal <b>c)</b> 60 l /16 US gal                              | <b>a)</b> 75 l /20 US gal <b>c)</b> 60 l /16 US gal /longopac                      |
| Flow at open inlet            | 500 m <sup>3</sup> /h /294 cfm   | 600 m <sup>3</sup> /h /353 cfm   | 700 m <sup>3</sup> /h /412 cfm   | 500 m <sup>3</sup> /h /294 cfm   | 800 m <sup>3</sup> /h /471 cfm   |
| Negative pressure, max        | 25 kPa /100 inwg   | 24 kPa /96 inwg  | 22 kPa /88 inwg  | 40 kPa /160 inwg   | 28 kPa /112 inwg   |
| Power consumption             | 4 kW   | 10 hp  | 7.5 kW   | 9.2 kW /15hp   | 9.2 kW /15hp   |
| Sound level                   | 75 dB(A)   | 75 dB(A)   | 75 dB(A)   | 75 dB(A)   | 75 dB(A)   |
| Filter area, fine/HEPA filter | 5 m <sup>2</sup> /2.7 m <sup>2</sup><br>54 ft <sup>2</sup> /29 ft <sup>2</sup>     | 5 m <sup>2</sup> /3.7 m <sup>2</sup><br>54 ft <sup>2</sup> /29 ft <sup>2</sup>     | 5 m <sup>2</sup> /3.7 m <sup>2</sup><br>54 ft <sup>2</sup> /39.8 ft <sup>2</sup>   | 5 m <sup>2</sup> /3.7 m <sup>2</sup><br>54 ft <sup>2</sup> /39.8 ft <sup>2</sup> | 8.4 m <sup>2</sup> /3.7 m <sup>2</sup><br>54 ft <sup>2</sup> /39.8 ft <sup>2</sup> |

## Guide to the right machine

## Pressure generation and airflow of our machines

kPa vs m<sup>3</sup>/h

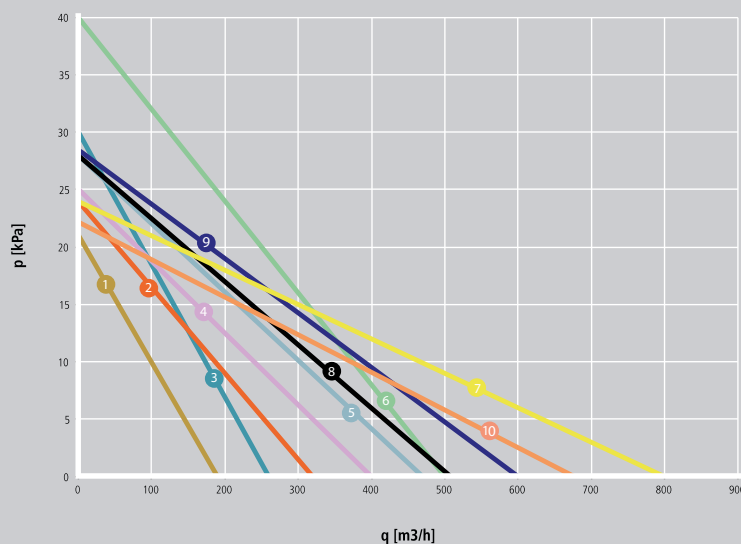

kPa vs m<sup>3</sup>/h

- 1 DC 2800H Asbest, DC 1800, DC 1800XL & DC 2900
- 2 DC 3900, DC 3900 Twin & DC 3800 Wood Shavings Extractor
- 3 DC 3900 Turbo & DC 3900 Twin Turbo
- 4 DC Tromb 400
- 5 DC 5900H Asbestos 4kW & DC 5900 PTFE
- 6 DC 5900 9.2kW S
- 7 DC 5900 9.2kW P
- 8 DC Storm 500
- 9 DC Storm 600
- 10 DC Storm 700

cfm vs inwg

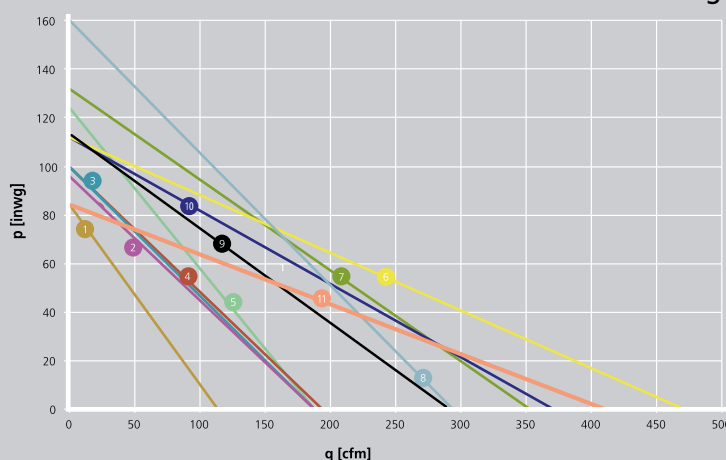

cfm vs inwg

- 1 DC 1800, DC 2900a, DC 2900c, DC 2800H Asbest
- 2 DC 3800 Wood Shavings Extractor
- 3 DC 3900a, DC 3900c, DC 3900L, DC 3900L
- 4 DC Tromb 400a, DC Tromb 400c, DC Tromb 400L
- 5 DC 3900c Turbo, DC 3900c Twin Turbo
- 6 DC 5900c 9.2 kW P
- 7 DC 5900H Asbestos 4 kW, DC 5900 PTFE
- 8 DC 5900c 9.2 kW S
- 9 DC Storm 500
- 10 DC Storm 600
- 11 DC Storm 700

# Semi-Mobile Systems

A semi-mobile system increases the accessibility to a powerful dust extractor on each floor. Instead of moving several small and large dust extractors around, each one requiring filter cleaning and filter replacement, several users can simultaneously connect their machines or power tools via a hose to a connection point. The sound level is reduced and it becomes easy for each team to clean up regularly, once the task has been completed.



# Semi-Mobile Systems

Semi-mobile dust collection systems are a practical solution when work is to be carried out on several floors and by several users at the same time. Each floor is connected to a central extraction system via a hose connection package and is equipped with a connection point for connecting the suction hose to the machine being used.

A Ø76 mm /3" hose that forms the main line is taken up through, for example, a lift shaft, refuse disposal chute or stairwell, and run to the dust extractor, which can in turn be connected to a pre-separator to collect larger particles, if necessary.



Part No 3353

## Hose connection package for semi-mobile systems

One package is used for each floor to facilitate installation.

The package does not include electrical cables or the startbox for vacuum producers (ordered separately).



## The branch pipe and hose connection package is supplied with (Part No)

|  |          |
|--|----------|
| 1 x Rubber plug with chain               | (4016)   |
| 1 x Hose, 2.5 m, 76 l                    | (2024)   |
| 2 x Joint Ø76 mm/3" (remove rubber ring) | (3007)   |
| 2 x Tube Ø76 mm /3" * 135                | (3341)   |
| 1 x Screw 6*40                           | (MC6S)   |
| 1 x Branch pipe 45°, Ø76 mm /3"          | (300311) |
| 1 x Flap valve Ø50/76 mm /2"/3"          | (3006)   |



One hose connection package is used for each floor.



Suction is available on each floor.



DC 5900, 9.2 kW P central unit with DCF Wheelbarrow pre-separator.





# Wet-Vacs

for those of you who deal with larger quantities of water,  
we have developed a line of professional wet-vacs that can  
handle the toughest environments.

## DC 50W

Powerful wet-vac

1-phase

When coring in concrete, large quantities of water are required, which becomes very dirty. Using a wet-vac to effectively extract the water prevents both the workplace from becoming wet and dirty, and the sewage system from silting up. The slurry solids are collected in a filter bag for easy handling and disposal.

Dustcontrol's wet-vacs are easy to disassemble for cleaning and decontamination. This is an important benefit on units that require frequent cleaning. Robust construction helps these units resist the knocks from everyday use.

### Part No

118600 DC 50W, 230V /50 Hz EU



### Supplied with (Part No)

Coupling socket (2108)  
Connecting sleeve (2114)  
Suction hose antistatic (Ø38 mm /1.5") 5 m /16ft (2012)  
Floor nozzle B370 mm /W14"(7236)  
Suction pipe (Ø38 mm) (7258)  
Filter bag (42190)



### Technical data

|                                 |                       |
|---------------------------------|-----------------------|
| H x W x D (cm/inch)             | 87x63x54 /34"x25"x21" |
| Weight                          | 34 kg /75 lbs         |
| Barrel size                     | 50 l /13 US gal       |
| Flow at open inlet              | 190 m³/h /111 cfm     |
| Negative pressure 230V          | 21 kPa /84 inwg       |
| Vacuum motor, single-phase 230V | 1285 W                |
| Pump, single-phase (W)          | 550                   |
| Sound level                     | 75 dB(A)              |

## DC 75W

Integrated slurry collection

1-phase



### Part No

118700 DC 75W, 230V /50 Hz EU



### Supplied with (Part No)

Coupling socket (2108)  
Connecting sleeve (2115)  
Suction hose antistatic (Ø38 mm /1.5") 5 m /16ft, (2012)  
Floor nozzle B370 mm /W14"(7236)  
Suction pipe (Ø38 mm) (7258)  
Filter bag (42190)



### Technical data

|                                 |                       |
|---------------------------------|-----------------------|
| H x W x D (cm/inch)             | 98x63x55 /38"x25"x21" |
| Weight                          | 37 kg /81 lbs         |
| Barrel size                     | 75 l /20 US gal       |
| Flow at open inlet              | 190 m³/h /111 cfm     |
| Negative pressure 230V          | 21 kPa /84 inwg       |
| Vacuum motor, single-phase 230V | 1285 W                |
| Pump, single-phase (W)          | 550                   |
| Sound level                     | 75 dB(A)              |







# Air Cleaners



# Air Cleaner

## DC AirCube 500

1-phase



The DC AirCube 500 has been developed for ease of use and durability. The fan unit is a radial blower, especially designed to build up high pressure across its entire flow range. This means that the unit generates a large amount of airflow during the entire lifetime of the filter. An exhaust hose can be used to create negative pressure in a sealed room. The fan has two speed settings, which means that the unit can be run economically, for example during the night.



| Part No | DC AirCube 500     |
|---------|--------------------|
| 112500  | 230V /50 Hz EU     |
| 112501  | 230V /50 Hz UK     |
| 112503  | 115V /50 Hz UK     |
| 112508  | 230V /50 Hz CH     |
| 112505  | 115V /60 Hz US/CAN |



### Accessories (Part No)

Hose Ø125 mm (2420)  
 Funnel connection (42753)  
 Hose clamp (4138)  
 HEPA H13 filter (42692)  
 Pre-filter G4 (42690)



### Technical data

|                        |                                     |
|------------------------|-------------------------------------|
| H x W x D (cm/inch)    | 38x34x50<br>/15"x13"x20"            |
| Weight                 | 13 kg /28.6 lbs                     |
| Inlet/Outlet           | 38x34 cm /Ø125<br>1.5x1.3 inch /Ø5" |
| Power consumption, fan | 195/210 W                           |
| Flow at open inlet     | 470/500 m³/h<br>276/320 cfm         |
| Pre-filter area        | 0.18 m² /1.9 ft²                    |
| HEPA filter area       | 4.56 m² /49 ft²                     |
| Filter class           | H13                                 |
| Sound level            | 45-65 dB (A)                        |

Dustcontrol's high-efficiency air cleaner – the DC AirCube – is equipped with a HEPA H13 filter to separate dust and particles down to 0.3 microns. The DC AirCube contributes to a healthier working environment.



The filter systems in all Dustcontrol dust extractors are built to comply with the stringent IEC machine classification H.

# Air Cleaner

## DC AirCube 1200



The DC AirCube 1200 is a highly efficient and robust air cleaner with the ability to clean the air even in large rooms, at a rate of up to 1.060 m<sup>3</sup>/h /647 cfm.

The encapsulated fan housing contains a radial blower type fan that builds up high pressure across its entire flow range, which provides effective air cleaning for the entire lifetime of the filter. The speed of the fan is also continuously variable in order to save energy.

The DC AirCube 1200 is equipped with both a HEPA H13 filter that captures the smallest particles and a light that indicates when it is time to replace the filter.



| Part No | DC AirCube 1200   |
|---------|-------------------|
| 111000  | 230V /50 Hz EU    |
| 111001  | 230V /50 Hz UK    |
| 111002  | 115V /50 Hz UK    |
| 111008  | 230V /50 Hz CH    |
| 111003  | 115V/60 Hz US/CAN |

### + Accessories (Part No)

Hose kit (42657)  
Bend 90° (42660)  
HEPA H13 filter (42940)  
Pre-filter G4 (42918)

### Technical data

|                         |   |
|-------------------------|---|
| H x W x D (cm/inch)     | 86x43x55/<br>34"x17"x21"                |
| Weight                  | 23 kg /51 lbs                           |
| Inlet/Outlet            | 25/31.5 cm<br>0.98/1.24 inch            |
| Power consumption, fan  | 375/385 W                               |
| Flow at open inlet, max | 1060 m <sup>3</sup> /h /680 cfm         |
| Pre-filter area         | 0.5 m <sup>2</sup> /4.3 ft <sup>2</sup> |
| HEPA filter area        | 5 m <sup>2</sup> /54 ft <sup>2</sup>    |
| Filter class            | H13                                     |
| Sound level             | 60-68 dB (A)                            |

## DC AirCube 2000



With a capacity of approximately 1.800 m<sup>3</sup>/h /1.059 cfm the DC AirCube 2000 is Dustcontrol's most powerful air cleaner.

The DC AirCube 2000 has a robust, stainless-steel chassis and an encapsulated fan with variable speed setting. With its ergonomic design, it is easy to carry and transport. It can also be operated when positioned horizontally.

The DC AirCube 2000 has a HEPA H13 filter with an area totalling 10 m<sup>2</sup> /107 ft<sup>2</sup>. An integrated light indicates when it is time to replace the filter.



| Part No | DC AirCube 2000    |
|---------|--------------------|
| 102000  | 230V /50 Hz EU     |
| 102002  | 230V /50 Hz UK     |
| 102003  | 115V /50 Hz UK     |
| 102008  | 230V /50 Hz CH     |
| 102004  | 115V /60 Hz US/CAN |

### + Accessories (Part No)

Hose kit (42657)  
Bend 90° (42660)  
HEPA H13 filter (42896)  
Pre-filter G4 (42917)

### Technical data

|                         |   |
|-------------------------|---|
| H x W x D (cm/inch)     | 102x56x70<br>/40"x22"x27"               |
| Weight                  | 30 kg /66 lbs                           |
| Inlet/Outlet            | 315/315 mm<br>12.4/12.4"                |
| Power consumption, fan  | 375/595 W                               |
| Flow at open inlet, max | 1850 m <sup>3</sup> /h /1187 cfm        |
| Pre-filter area         | 0.5 m <sup>2</sup> /5.4 ft <sup>2</sup> |
| HEPA filter area        | 10 m <sup>2</sup> /107 ft <sup>2</sup>  |
| Filter class            | H13                                     |
| Sound level             | 60-68 dB (A)                            |





# Decontamination Systems



# Decontamination Box

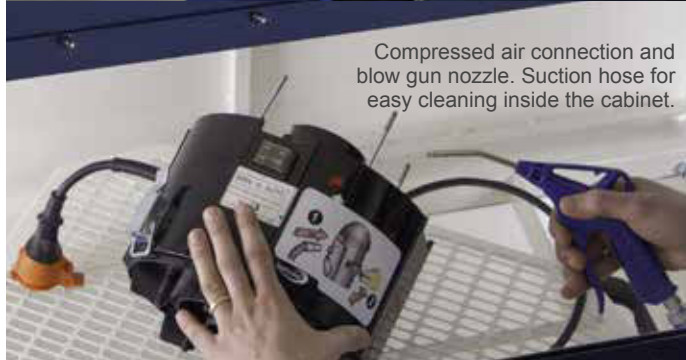
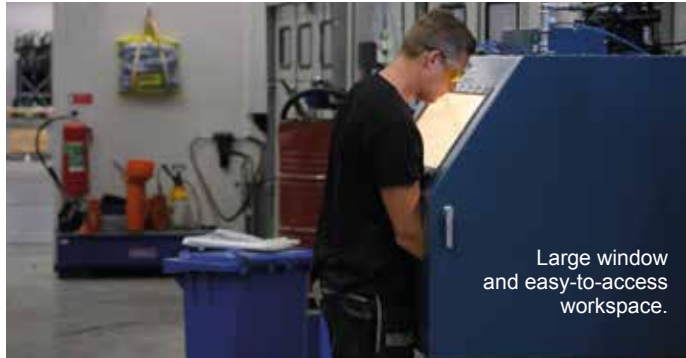

## DC Box

The DC Box is a specially designed dust extraction cabinet that protects against hazardous dust during decontamination and cleaning before servicing or repairing machines and tools. The DC Box is equipped with a compressed air nozzle and a suction hose for vacuum cleaning. Larger particles and debris fall down into a plastic bag attached to the bottom of the cabinet.

The DC Box is easy to work with. Tools and machines are placed onto the rotating worktable and slid in through the side door. These are then cleaned either by vacuuming or using compressed air. The fine dust is vacuumed up and transported away via a tubing system to a complete central unit located either in or outdoors. The size of the central unit and dimensioning of the tubing system is tailored to the needs of the customer. The system can be expanded so that it can also be used as a central extraction system with connections that are easily accessible across the entire worksite.

The DC Box is available in three versions: small, medium and large.

**The DC Box Small** uses the DC AirCube 500 air cleaner to evacuate dust laden air from inside and is ideal for use in smaller premises. A mobile vacuum unit can be externally connected to the integral hose cleaning point.

**The DC Box Medium** is the ideal solution for users with a greater throughput. Equipped with a pre-separator and DC 11-Module 11kWp/15 hp central unit and typically designed in conjunction with a centralised workshop vac system for a complete solution.

**DC Box Large.** If you want to be able to wheel taller equipment directly into the cabinet for decontamination, then the DC Box Large is the solution for you. It can be customised to requirement.

### Customized after your requirements



DC Box



DC F Mobile

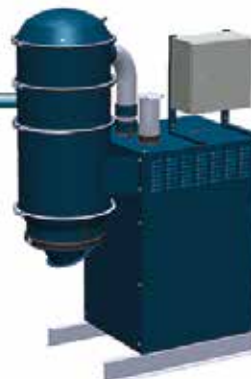

DC 11-Module





## The DC Box Medium Package is supplied with (Part No)

|       |   |
|-------|---|
| 7470  | DC Box  |
| 42014 | Trolley   |
| 7074  | DCF Mobile Pre-Separator                        |
|       | DC 11-Module 11 kW P central unit tubing system |

Contact your sales representative for correct dimensioning and a quotation for DC Box Packages.



**DC Box Medium**  
7470 DC Box standard



## Technical data DC 11-Module 11 kW P/15hp

|                                |                          |
|--------------------------------|--------------------------|
| H x W x D (cm/inch)            | 180x100x130 /71"x40"x51" |
| Weight                         | 260 kg /573 lbs          |
| Inlet/Outlet                   | Ø180 mm /7"              |
| Filter cleaning compressed air | 4 l/s /3 804 gph         |
| Flow                           | 800 m³/h /28 250 ft³/h   |
| Negative pressure, max         | 22 kPa /88 inwg          |
| Filter area                    | 8.4 m² /90.4ft²          |
| Degree of separation           | >99.9%                   |
| Sound level                    | 60-63 dB(A)              |



## Technical data AirCube 500

|                        |                                     |
|------------------------|-------------------------------------|
| H x W x D (cm/inch)    | 38x34x50<br>/15"x13"x20"            |
| Weight                 | 13 kg /28.7 lbs                     |
| Inlet/Outlet           | 38x34 cm /Ø125<br>1.5x1.3 inch /Ø5" |
| Power consumption, fan | 195/210 W                           |
| Flow at open inlet     | 470/500 m³/h<br>276/353 cfm         |
| Pre-filter area        | 0.18 m² /1.9 ft²                    |
| HEPA filter area       | 4.56 m² /49 ft²                     |
| Filter class           | H13                                 |
| Sound level            | 45-65 dB (A)                        |



**DC Box Small Complete**  
with DC AirCube 500, 50 Hz  
74701 230V EU, 74702 230V UK



**DC Box Large**  
Customised to your requirements



## Technical data DC Box Medium and Small

|                     |                         |
|---------------------|-------------------------|
| H x W x D (cm/inch) | 180x120x80 /71"x48"x32" |
| Weight              | 160 kg /353 lbs         |
| Inlet/Outlet        | Ø76 mm /3"              |
| Max flow            | 600 m³/h /353 cfm       |

The image shows two blue industrial pre-separators in a workshop. The one in the foreground is a tall, cylindrical unit with a conical bottom, featuring a top access panel with latches and a side outlet. It is surrounded by coiled black corrugated hoses. In the background, another similar unit is visible, equipped with a horizontal inlet pipe and a top elbow outlet. The scene is set against a concrete wall with various workshop items in the background.

# Pre-Separators



# Pre-Separators

Pre-Separators can be used in all applications where the extracted material is coarse or voluminous. These can be placed in the actual workplace for separate handling or recovery of the extracted material, or centrally to relieve filter loading.

Pre-Separators separate material from the air flow using the action of a cyclone or with inertial separation.

The Cyclone Principle is very effective in separating particles down to 1/100 mm.

Inertial separators are generally configured as containers with the inlet and outlet in the same wall of the container. When the air flow changes direction abruptly, separation occurs for the particles with higher relative mass.



**Cyclone Principle** meaning that the inlet is mounted tangentially on the body and the air flow is thus forced against the inside of the cyclone.

## When a Pre-Separator is to be used the following should be considered:

1. Type of dust to be handled.
2. How the unit should be placed and how emptying will be performed.
3. Expected airflow.

## Pre-Separators should be used:

- for material recovery.
- for material transportation.
- to reduce the loading on the ducting system.
- to relieve loading on the central filter.
- to reduce the risk of filter clogging.
- when fluids are to be separated.

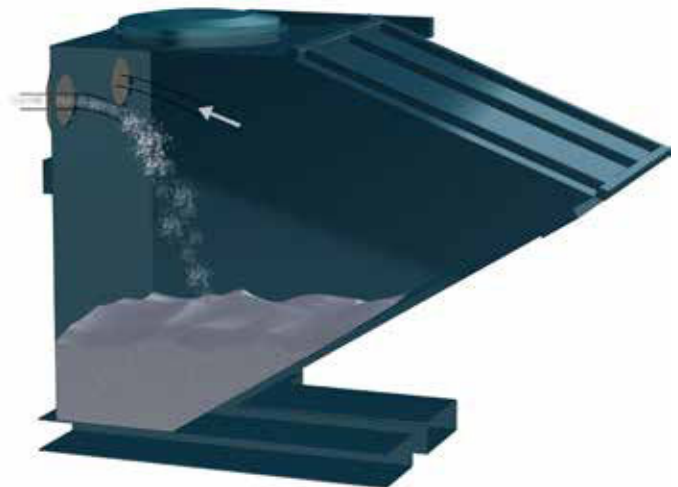

**Inertial Principle** meaning that the air stream flows into the container and abruptly changes course.



## DCF 2800

Light and easy to use

The DCF 2800 pre-separator is often used in combination with the DC 2900 dust extractor to relieve the loading on the filter.

### Part No

7372 DCF 2800



### Supplied with (Part No)

Plastic bags (42702)



### Technical data

|                     |                         |
|---------------------|-------------------------|
| H x W x D (cm/inch) | 100x54x45 / 39"x21"x18" |
| Weight              | 10 kg / 22 lbs          |
| Inlet/Outlet        | Ø50 mm / 2"             |
| Cyclone diameter    | Ø250 mm / 10"           |
| Collection          | 40 l / 10 US gal        |

## DCF 3900

High capacity, low weight

The DCF 3900 is a robust pre-separator that has been designed to deal with medium quantities of dust, especially when grinding. The chassis is adjustable to make it easier to transport. Thanks to its large inlet, it is also suitable for the collection of coarser types dust. The DCF 3900 separates 90% of the dust, thus relieving the load on the dust extractor. This means that the container/bag does not have to be emptied as often. The pre-separator can be connected to our DC 1800 eco, DC 2900 eco and DC 3900 eco dust extractors.

### Part No

703900 DCF 3900L  
703901 DCF 3900c



### Supplied with (Part No)

The DCF 3900L is supplied with longopac 22 m / 72 ft (432177)

The DCF 3900c is supplied with 10 x plastic bags (43619)



### Technical data

|                     |                         |
|---------------------|-------------------------|
| H x W x D (cm/inch) | 154x60x78 / 60"x23"x31" |
| Weight              | 25 kg / 55 lbs          |
| Inlet/Outlet        | Ø50 mm / 2"             |
| Airflow, max        | 320 m³/h 188 cfm        |

## DCF 60

### Wooden floor grinding

The DCF 60 pre-separator can handle large quantities of light dust. Due to its large inlet the pre-separator is also well suited to separate coarse dirt. Perfect for wooden floor grinding.

**Part No**  
7069 DCF 60



#### Technical data

|                     |                        |
|---------------------|------------------------|
| H x W x D (cm/inch) | 106x38x38 /42"x15"x15" |
| Weight              | 10 kg /22 lbs          |
| Inlet               | Ø50 mm /2"             |
| Container           | 55 l /14 US gal        |

## DCF Storm

### For large quantities of dust

The DCF Storm is ideal for floor grinding and semi-mobile systems and could be set apart to handle large and heavy quantities of dust. The pre-separator relieves the loading on the filter in the vacuum source and is equipped with a longopac solution for dust-free bag changing, so that the user can minimise unnecessary and time-consuming stoppages. Also available as a standard "c" model with an intellibag.

**Part No**  
70701 DCF Storm L  
70700 DCF Storm c



#### Supplied with (Part No)

DCFStorm L, longopac 25 m /82 ft (44077)  
or DCFStorm c, plastic bags (46145)



#### Technical data

|                     |                         |
|---------------------|-------------------------|
| H x W x D (cm/inch) | 185x70x108 /73"x27"x42" |
| Weight              | 46 kg /101 lbs          |
| Inlet               | Ø108 mm /4"             |
| Airflow, max        | 700 m³/h /412 cfm       |



## DCF Cyclone Separator Cover

### Practical when there is a lot of dust

When large quantities of dust are produced, a DC 5900, for example, can be supplemented with a cyclone separator cover that is fitted directly onto a standard 200-litre /53 US gal barrel.

**Part No**  
7367 Cyclone separator cover



#### Technical data

|                      |               |
|----------------------|---------------|
| Height (cm/inch)     | 58/23"        |
| Weight               | 10 kg /22 lbs |
| Inlet/Outlet         | Ø76 mm /3"    |
| Cyclone diameter     | Ø250 mm /10"  |
| For barrel diameter* | Ø620 mm /24"  |

\* Barrel not included



# DCF Wheelbarrow

Easy handling

The DCF Wheelbarrow is a mobile pre-separator designed like a wheelbarrow for ease of use. A small cyclone with two inlets is fitted in the container. Two tools, cleaning implements etc. can be connected at the same time. The container also has a special hatch so that material can be shovelled in and out.



## Technical data

|                      |                         |
|----------------------|-------------------------|
| H x W x D (cm/inch)  | 120x135x64 /47"x53"x25" |
| Weight               | 50 kg /110 lbs          |
| Inlet x 2/Outlet x 1 | Ø76 mm /3"              |
| Cyclone diameter     | Ø250 mm /10"            |
| Filling volume       | 120 l /32 US gal        |

### Part No

7130 DCF Wheelbarrow



# DCF Tipping Container

For large quantities of coarse material

Tipping containers can be used as inertial separators by equipping the container with a divider baffle and fitting hoses onto the inlet/outlet connections on the rear wall of the container.

Inertial separation is particularly suitable when large quantities of coarse material are involved.



## Technical data

### DCF Tipping Container 0.6m³/158 gal

|                        |                          |
|------------------------|--------------------------|
| H x W x D (cm/inch)    | 118x108x159 /46"x42"x62" |
| Weight                 | 240 kg /529 lbs          |
| Total volume           | 0.6 m³ /158 US gal       |
| Filling volume         | 0.3 m³ /79 US gal        |
| Negative pressure, max | 40 kPa /160 inwg         |

## Technical data

### DCF Tipping Container 2.5m³/660 gal

|                        |                          |
|------------------------|--------------------------|
| H x W x D (cm/inch)    | 147x128x218 /58"x50"x86" |
| Weight                 | 570 kg /1257 lbs         |
| Total volume           | 2.5 m³ /660 US gal       |
| Filling volume         | 1.3 m³ /343 US gal       |
| Negative pressure, max | 40 kPa /160 inwg         |

### Part No DCF Tipping Container

|      |                |
|------|----------------|
| 7196 | 0.6 m³/158 gal |
| 7198 | 2.5 m³/660 gal |





## The most hazardous dust is the dust you can't see.

The smaller a particle is, the deeper into the pulmonary system it penetrates. Respirable dust, the dust we inhale, is made up of particles smaller than 5 thousands of a millimetre ( $5\text{ }\mu\text{m}$ ). Because the particles are so small, they can penetrate into the deepest parts of the pulmonary system where the air moves too slowly to be able to breathe them out again.

The lungs' way of protecting themselves is to wrap the foreign particles in nodules of connective tissue, which, in time, leads to pneumoconiosis or COPD (Chronic Obstructive Pulmonary Disease). Some types of particles, such as silica and asbestos dust, cannot be broken down by the body and are also sharp, which is why they continue to cause damage long after they have become lodged in the lungs.

The best protection is to remove dust at the source and never allow it to reach the air. Dustcontrol has developed suction casings for most handheld and stationary machines, and also produces tailor-made suction casings.

# Classification of Dust Extractors and HEPA Filters

Dust extractors are used to improve the working environment, and to reduce levels of hazardous dust in the air to a minimum. This places great demands on the ability of the dust extractor to separate fine dust. We use a fine filter in our mobile dust extractors, which separates most of the dust. But in order to capture close to 100 % of the finest and most dangerous particles, we always complete the design with a HEPA H13 filter.

Here at Dustcontrol, we use conical pleated filters in all of our dust extraction units. A pleated filter has a very large area in relation to its physical size. The dust extractors can therefore be compact in relation to the large filter area they contain.

Only original Dustcontrol filters are tested and approved for use in our machines. The use of other types of filters could lead to the leaking of hazardous dust and/or machine breakdown. Dustcontrol's warranty only applies to machines equipped with original Dustcontrol spare parts. The filters are certified in accordance with current European requirements for dust extraction. This ensures that, with correct handling, optimum filtration will be achieved. Follow the instructions when handling filters, so that they can be replaced without exposure to hazardous dust.

To ensure that the filters comply with the requirements of relevant regulations for health and safety at work, a number of different testing standards are used. These are described below:

## Test methods

The test methods used in current standards for dust extractors and filters are always based on particle counting. By injecting particles before the filter and by using a particle counter to determine the concentration before and after the filter, the penetration can be calculated (a penetration of 0.1% is equal to a degree of separation of 99.9 %). The test is carried out in

several stages by individually examining the filter media, the complete filter cartridge and, in some cases, also the complete unit.

## HEPA filters — High Efficiency Particulate Air Filters

When classifying HEPA filters, Dustcontrol uses the strict HEPA standard (EN 1822-1). It is divided into different levels (E10 to H14) depending on filtration efficiency. Dustcontrol applies level H13, which can separate up to 99.95 % of the particles between 0.15 and 0.30  $\mu\text{m}$  in size. This particle size is used because it is the hardest to separate – both larger and smaller particles are easier to capture in a filter.

## Dust extractors

In IEC-60335-2-69 (EN-60335-2-69), the standard for testing wet and dry extractors, dust extractors are classified into three categories – **L for low, M for medium and H for high** – where the H category is the most stringent. (Please note: do not confuse this “H” with that in HEPA H13). The category required for a specific application is decided on the basis of the permitted maximum concentration for that type of dust (MAK) in the working environment or by local regulations.

## The test according to EN-60335-2-69 comprises two parts:

**1. A test of the filter system** – in our case, a fine filter and a HEPA H13 filter. To achieve category H, a degree of separation of 99.995 % is required, where 90% of the test particles must be smaller than 1.0  $\mu\text{m}$ . Our fine filters comply with category M, and our HEPA H13 filters with category H.

**2. A test of the “assembled unit”** – in our case, a complete dust extractor. Here, 99.995 % efficiency is also required, however 10 % of the particles must be smaller than 1.0  $\mu\text{m}$ , 22 % smaller than 2.0  $\mu\text{m}$ , and 75 % smaller than 5.0  $\mu\text{m}$ .



The filter systems in all Dustcontrol dust extractors are built to comply with the stringent IEC machine classification H.



## Classification of our Dust Extractors

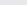
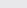

| NAME             | CLASSIFICATION   | STANDARD       | EFFICIENCY | PARTICLE SIZE  | EXAMPLE   | MAK (Maximum Work-<br>place Concentration)                         |
|------------------|--|----------------|------------|----------------|-----------|--|
|                  | L=  |                | > 99%      |                |           | > 1.0 mg/m³  |
|                  | M=  |                | > 99.9%    |                |           | > 0.1 mg/m³  |
| IEC*<br>standard | H=  | IEC 60335-2-69 | >99.995%   | 0.1 - 5.0 µm** | H=99.995% | < 0.1 mg/m³ and car-<br>cinogenic substances<br>including asbestos |

\* IEC: International Electrotechnical Commission

\*\* Part 1: 90 % < 1.0  $\mu\text{m}$       Part 2: 10 % < 1.0  $\mu\text{m}$   
 22 % < 2.0  $\mu\text{m}$   
 75 % < 5.0  $\mu\text{m}$

## Classification of our HEPA filters



| NAME  | CLASSIFICATION | STANDARD           | EFFICIENCY | PARTICLE SIZE               | EXAMPLE           |
|-------|----------------|--------------------|------------|-----------------------------|-------------------|
| HEPA* | E10            | EN 1822-1          | 85%        | MPPS** between 0.15–0.30 µm |                   |
|       | E11            |                    | 95%        |                             |                   |
|       | E12            |                    | 99.5%      |                             |                   |
|       | H13            |                    | 99.95%     | HEPA H13 = 99.95 %          |                   |
| DOP   |                | US IAW MIL-STD 282 | 99.97%     | 0.30 µm                     | DOP H13 = 99.97 % |

\* High Efficiency Particle Air filter

\*\* Most Penetrating Particle Size

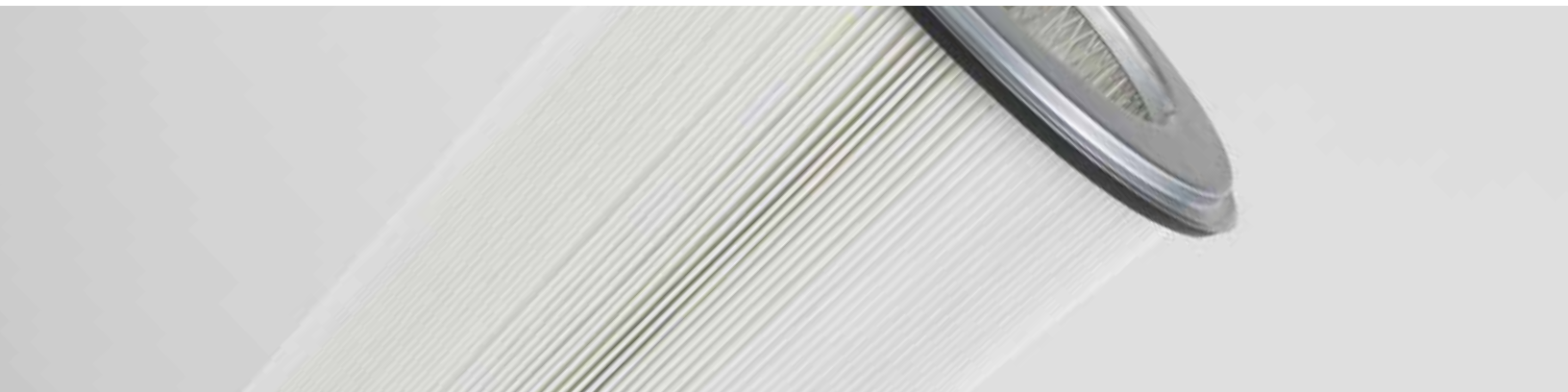



# Accessories and Hoses

A worker wearing a black long-sleeved shirt, dark cargo pants, a black tool belt, an orange hard hat, and large green earplugs is using a Dustcontrol vacuum system. The worker is holding a long, flexible black hose that is connected to a silver metal wand. The wand is positioned against a white wall in a long, brightly lit industrial corridor with many windows. In the foreground, the Dustcontrol DC 1800 vacuum unit is visible, which is a black and blue canister with a handle and various hoses attached. The floor is a light-colored concrete.

In order for you to get the most out of your Dustcontrol, you need the right accessories. We supply cleaning equipment in all sorts of designs and materials. If something is missing, we can even manufacture customised solutions. Please speak to your sales representative for more information.

# Cleaning accessories Ø 1.5"/38 mm

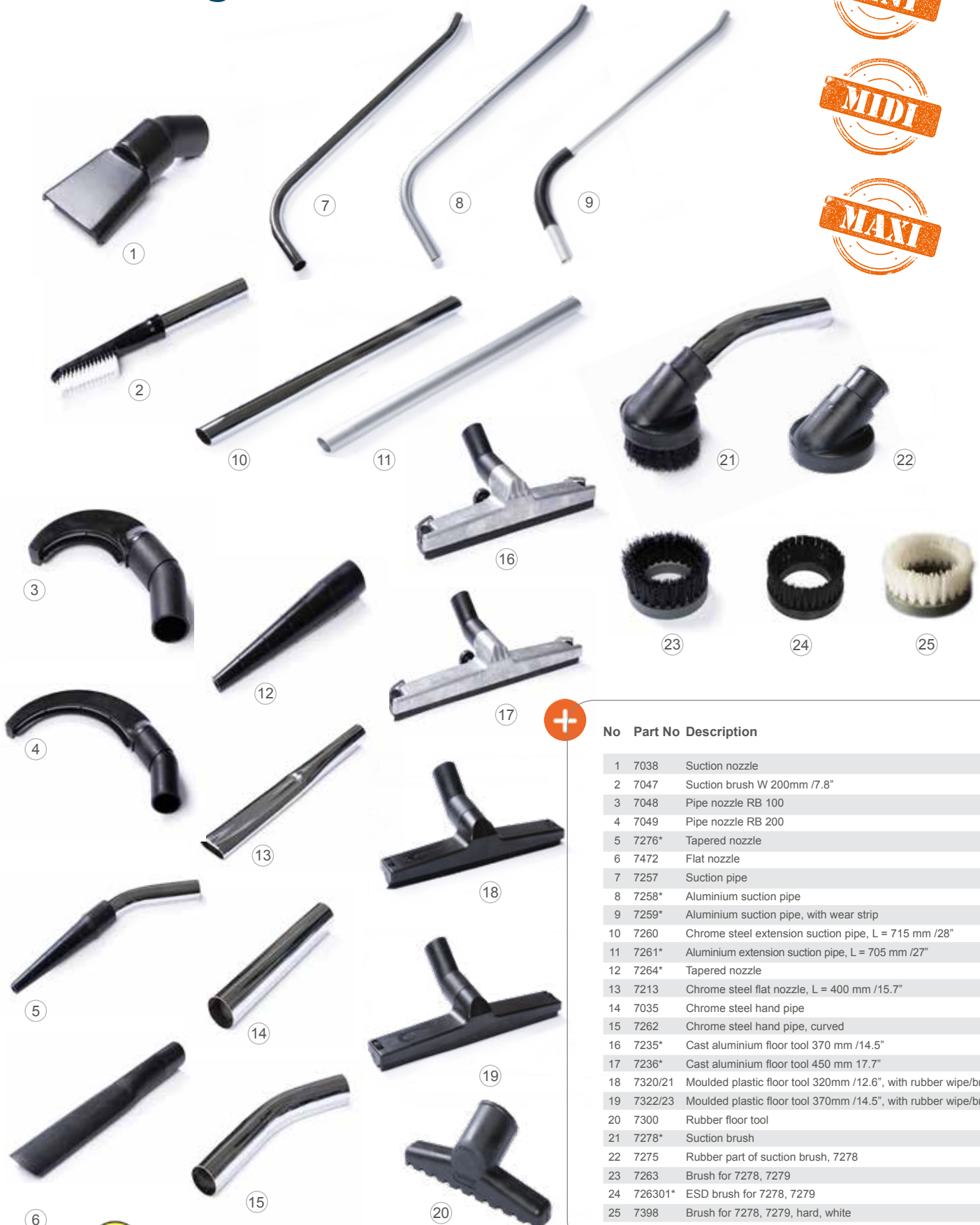

## No Part No Description

|    |         |   |
|----|---------|---|
| 1  | 7038    | Suction nozzle  |
| 2  | 7047    | Suction brush W 200mm /7.8"                                     |
| 3  | 7048    | Pipe nozzle RB 100  |
| 4  | 7049    | Pipe nozzle RB 200  |
| 5  | 7276*   | Tapered nozzle  |
| 6  | 7472    | Flat nozzle   |
| 7  | 7257    | Suction pipe  |
| 8  | 7258*   | Aluminium suction pipe  |
| 9  | 7259*   | Aluminium suction pipe, with wear strip                         |
| 10 | 7260    | Chrome steel extension suction pipe, L = 715 mm /28"            |
| 11 | 7261*   | Aluminium extension suction pipe, L = 705 mm /27"               |
| 12 | 7264*   | Tapered nozzle  |
| 13 | 7213    | Chrome steel flat nozzle, L = 400 mm /15.7"                     |
| 14 | 7035    | Chrome steel hand pipe  |
| 15 | 7262    | Chrome steel hand pipe, curved                                  |
| 16 | 7235*   | Cast aluminium floor tool 370 mm /14.5"                         |
| 17 | 7236*   | Cast aluminium floor tool 450 mm 17.7"                          |
| 18 | 7320/21 | Moulded plastic floor tool 320mm /12.6", with rubber wipe/brush |
| 19 | 7322/23 | Moulded plastic floor tool 370mm /14.5", with rubber wipe/brush |
| 20 | 7300    | Rubber floor tool   |
| 21 | 7278*   | Suction brush   |
| 22 | 7275    | Rubber part of suction brush, 7278                              |
| 23 | 7263    | Brush for 7278, 7279  |
| 24 | 726301* | ESD brush for 7278, 7279  |
| 25 | 7398    | Brush for 7278, 7279, hard, white                               |



\* To order an antistatic (ESD) version, add the letter E to the end of the part no.

\*\* The wire helix must be bared and left in contact with conductive material for static discharge.



# Cleaning accessories Ø 2"/50 mm



ERGO Grip for better handling.  
Fits on all Ø50 /2" suction  
pipes and Ø50 /2" bulk nozzle.



\* To order an antistatic (ESD) version, add the letter E to the end of the part no.

\*\* The wire helix must be bared and left in contact with conductive material for static discharge.



## No Part No Description

|    |         |   |
|----|---------|---|
| 1  | 7266    | Aluminium suction pipe                  |
| 2  | 7267    | Aluminium suction pipe, with wear strip |
| 3  | 7265    | Suction pipe                            |
| 4  | 7268/69 | Chrome steel extension pipe, 710 mm/28" |
|    |         | Aluminium extension pipe, 710 mm/28"    |
| 5  | 7033    | Chrome steel hand pipe                  |
| 6  | 7271    | Chrome steel hand pipe, curved          |
| 7  | 7285    | ERGO Grip handle                        |
| 8  | 7272*   | Tapered nozzle                          |
| 9  | 7277*   | Tapered nozzle                          |
| 10 | 7212    | Flat nozzle, L = 400 mm /15.7"          |
| 11 | 7295    | Bulk nozzle                             |
| 12 | 7013    | Rubber floor tool                       |
| 13 | 7281*   | Floor nozzle W 200 mm /7.8"             |
| 14 | 7238*   | Cast aluminium floor tool, 500 mm/19.6" |
| 15 | 7307    | Gulper floor tool, aluminium            |
| 16 | 7149    | Chip nozzle 50x70x243 / 1.9"x2.7"x9.6"  |
| 17 | 7030    | Suction nozzle                          |
| 18 | 7279*   | Suction brush                           |
| 19 | 7016*   | Suction nozzle with brush               |
| 20 | 7274    | Rubber part for suction brush           |
| 21 | 7263    | Brush for 7278, 7279                    |
| 22 | 726301* | ESD brush for 7278, 7279                |
| 23 | 7398    | Brush for 7278, 7279, hard, white       |



# Cleaning accessories Ø 3"/76 mm

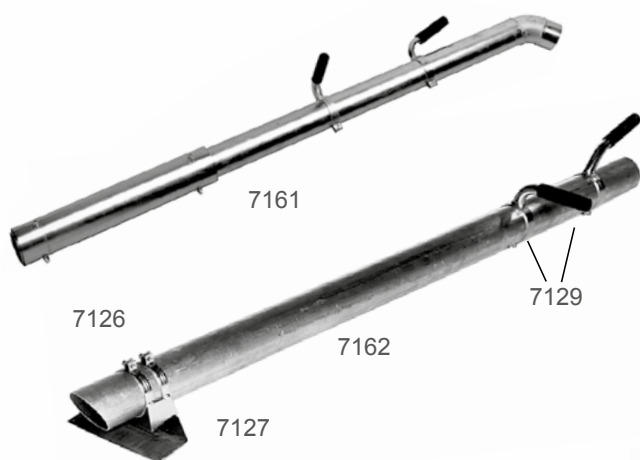

| Part No | Description               |
|---------|---------------------------|
| 7126    | Clamp for scraper         |
| 7127    | Scraper for suction lance |
| 7129    | Handle, complete          |
| 7161    | Bulk nozzle               |
| 7162    | Suction lance             |



# About Suction Hoses

Hoses need to have different characteristics depending on their intended use. Dustcontrol supplies hoses that are:

- wear-resistant, lightweight and flexible
- unaffected by extremes of temperature
- crushproof
- antistatic

When using long suction hoses that are coupled together, the hose closest to the suction casing should be the one with the smallest diameter and it should be no longer than 9,8 ft /3 m. Coupling should be carried out using external couplings that are easy to use.

## Our selection of Suction Hoses

| Product                                    | Part No | Dimension Ø | Standard length ft /m | Colour      | Material | Temp °F /°C max/min | Anti-static/ESD | Abrasion resistance | UV and ozone resistance | Resistance to welding fumes | Resistance to solvent and oil |
|--|---------|-------------|-----------------------|-------------|----------|---------------------|-----------------|---------------------|-------------------------|-----------------------------|-------------------------------|
| Suction hoses, standard                    | 2001    | 3"/76 mm    | 32 /10                | Blue        | PE       | 140/-22/+60/-30     | No              | 2                   | 2                       | 3                           | 3                             |
|  | 2401    | 2"/50 mm    | 16,32,49 /5,10,15     | Blue        | PE       | 140/-22/+60/-30     | No              | 2                   | 2                       | 3                           | 3                             |
|  | 2111    | 1.5"/38 mm  | 16,32,49 /5,10,15     | Blue        | PE       | 140/-22/+60/-30     | No              | 2                   | 2                       | 3                           | 3                             |
|  | 2112    | 1.25"/32 mm | 16,32,49 /5,10,15     | Blue        | PE       | 140/-22/+60/-30     | No              | 2                   | 2                       | 3                           | 3                             |
|  | 2113    | 1"/25 mm    | 16,32,49 /5,10,15     | Blue        | PE       | 140/-22/+60/-30     | No              | 2                   | 2                       | 3                           | 3                             |
| Suction hoses, heat-resistant              | 2004    | 2"/50 mm    | 16,32,49 /5,10,15     | Grey        | PP(EPDM) | 194/-40/+90/-40     | No              | 3                   | 2                       | 1                           | 4                             |
|  | 2003    | 1.5"/38 mm  | 16,32,49 /5,10,15     | Grey        | PP(EPDM) | 194/-40/+90/-40     | No              | 3                   | 2                       | 1                           | 4                             |
| Suction hoses, antistatic                  | 2024*   | 3"/76 mm    | 32 /10                | Black       | PE       | 140/-4/+60/-20      | Yes             | 2                   | 2                       | 3                           | 3                             |
|  | 2013*   | 2"/50 mm    | 16,32,49 /5,10,15     | Black       | PE       | 140/-4/+60/-20      | Yes             | 2                   | 2                       | 3                           | 3                             |
|  | 2012*   | 1.5"/38 mm  | 16,32,49 /5,10,15     | Black       | PE       | 140/-4/+60/-20      | Yes             | 2                   | 2                       | 3                           | 3                             |
|  | 2005*   | 1.25"/32 mm | 16,32,49 /5,10,15     | Black       | PE       | 140/-4/+60/-20      | Yes             | 2                   | 2                       | 3                           | 3                             |
|  | 2025*   | 1"/25 mm    | 16,32,49 /5,10,15     | Black       | PE       | 140/-4/+60/-20      | Yes             | 2                   | 2                       | 3                           | 3                             |
|  | 2027E*  | 1.5"/38 mm  | 16,32,49 /5,10,15     | Black       | PE       | 140/-4/+60/-20      | Yes             | 2                   | 2                       | 3                           | 3                             |
|  | 2028E*  | 2"/50 mm    | 16,32,49 /5,10,15     | Black       | PE       | 140/-4/+60/-20      | Yes             | 2                   | 2                       | 3                           | 3                             |
| Suction hoses, PU extra abrasion-resistant | 2056    | 3"/76 mm    | 16 & 32 /5 & 10       | Transparent | PU       | 194/-40/+90/-40     | Yes**           | 1                   | 1                       | 3                           | 1                             |
|  | 2054    | 2"/50 mm    | 16 & 32 /5 & 10       |             | PU       | 194/-40/+90/-40     | Yes**           | 1                   | 1                       | 3                           | 1                             |
|  | 2055    | 1.5"/38 mm  | 16 & 32 /5 & 10       |             | PU       | 194/-40/+90/-40     | Yes**           | 1                   | 1                       | 3                           | 1                             |
| Super D superelastic                       | 2038    | 1.5"/38 mm  | 49 /15                | Black/white | PVC      | 185/-23/+85/-5      | No              | 2                   | 2                       | 2                           | 4                             |
|  | 2039    | 2"/50 mm    | 49 /15                | Black/white | PVC      | 185/-23/+85/-5      | No              | 2                   | 2                       | 2                           | 4                             |

### Resistance Scale

- 1 Excellent
- 2 Good
- 3 Limited
- 4 Poor



\* To order an antistatic (ESD) version, add the letter E to the end of the part no.

\*\* The wire helix must be bared and left in contact with conductive material for static discharge.

# Suction Hoses

## Turnable Hose Connectors

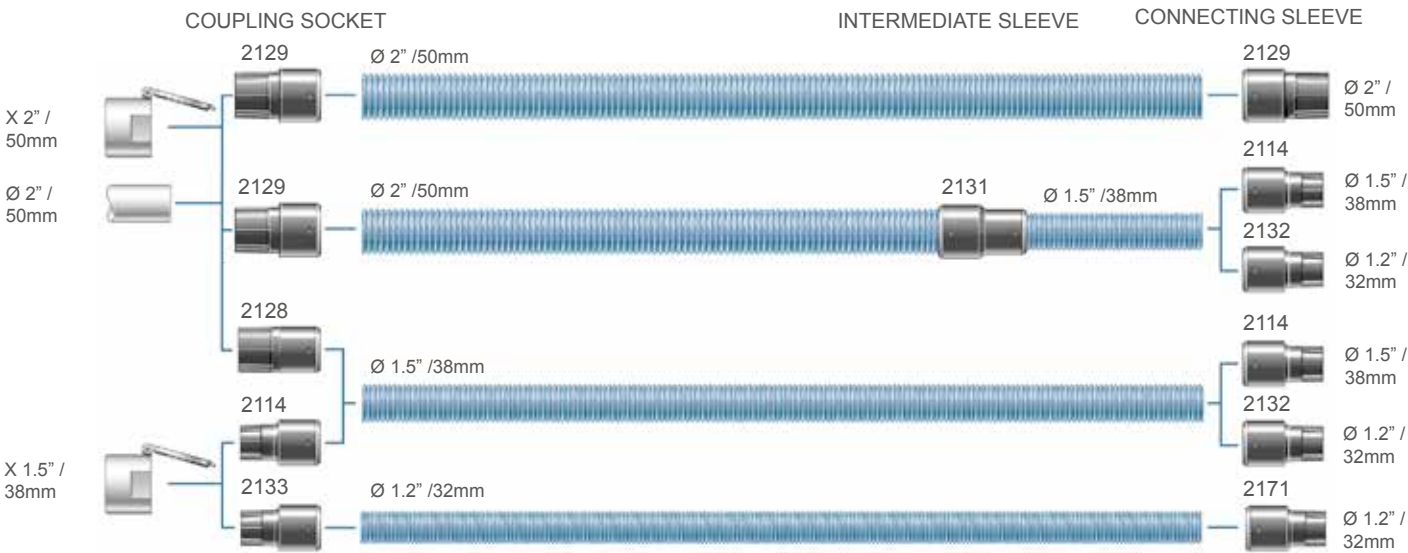

| Part No | Description                                    |
|---------|--|
| 2114*   | Connecting sleeve, turnable Ø 1.5"/1.5" /38/38 |
| 2128*   | Coupling socket, turnable Ø 2"/1.5" /50/38     |
| 2129*   | Coupling socket, turnable Ø 2"/2" /50/50       |
| 2131*   | Intermediate sleeve, turnable Ø 2"/1.5" /50/38 |
| 2132*   | Connecting sleeve, turnable Ø 1.2"/1.5" /32/38 |
| 2133*   | Coupling socket, turnable Ø 1.5"/1.2" /38/32   |
| 2171*   | Coupling socket, turnable Ø 1.2"/1.2" /32/32   |

\*To order an antistatic (ESD) version, add E to the end of part no.





# Suction Hoses

## Non-Turnable Hose Connectors

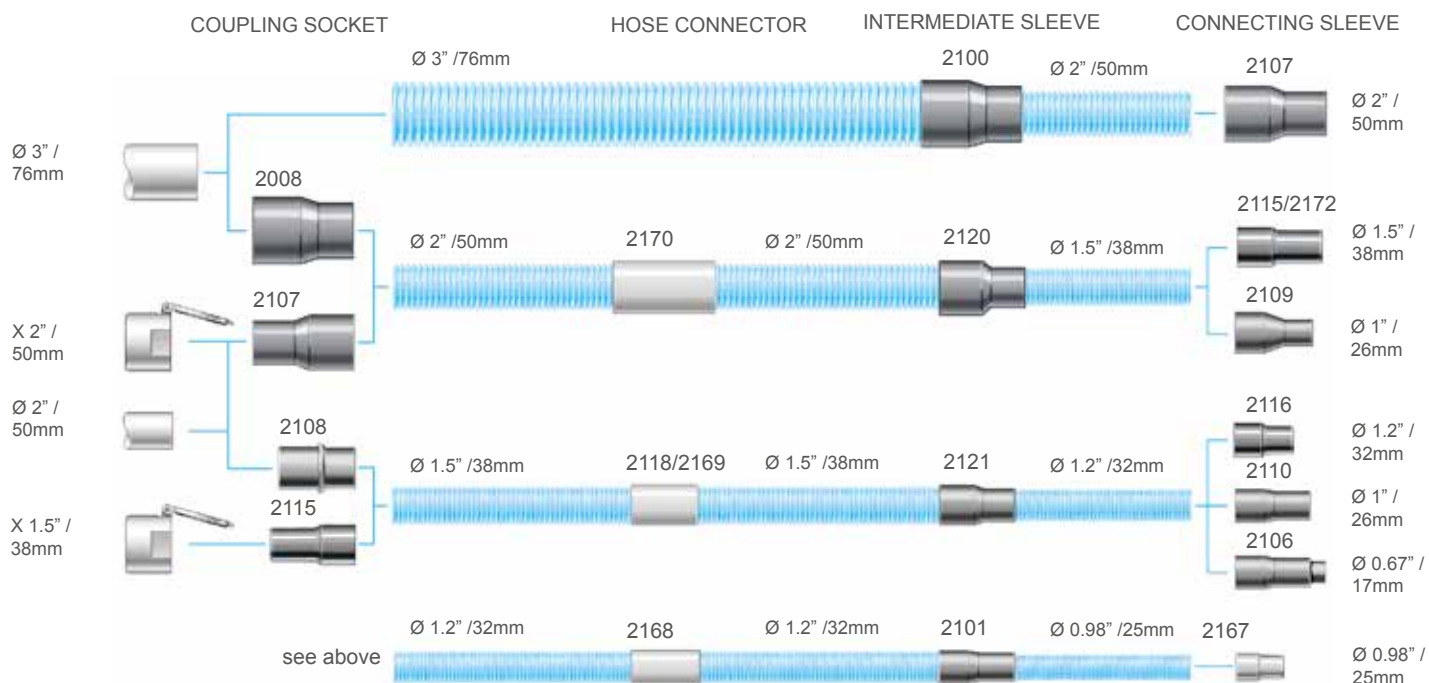

### Part No Description

|       |   |
|-------|---|
| 2008* | Coupling socket Ø 3"/2" /76/50          |
| 2100* | Intermediate sleeve Ø 3"/2" /76/50      |
| 2101* | Intermediate sleeve Ø 1.2"/0.98" /32/25 |
| 2106* | Connecting sleeve Ø 0.67"/1.2" /17/32   |
| 2107* | Coupling socket Ø 2"/2" /50/50          |
| 2108* | Coupling socket Ø 2"/1.5" /50/38        |
| 2109* | Connecting sleeve Ø 1"/1.5" /26/38      |
| 2110* | Connecting sleeve Ø 1"/1.2" /26/32      |
| 2115* | Connecting sleeve Ø 1.5"/1.5" /38/38    |

|       |  |
|-------|--|
| 2116  | Connecting sleeve Ø 1.2"/1.2 /32/32  |
| 2120* | Intermediate sleeve Ø 2"/1.5" /50/38   |
| 2121* | Intermediate sleeve Ø 1.5"/1.2" /38/32   |
| 2156* | Coupling Nipple 75/72.5. 2156 is used to connect the 76mm hose to flap valve, 76/76 part no 3237 |

|       |  |
|-------|--|
| 2167* | Connecting sleeve Ø 0.98"/0.98" /25/25 |
| 2168* | Hose connector Ø 1.2" /32              |
| 2169* | Hose connector Ø 1.5" /38              |
| 2170* | Hose connector Ø 2" /50                |



\* To order an antistatic (ESD) version, add the letter E to the end of the part no.

\*\* The wire helix must be bared and left in contact with conductive material for static discharge.



# Suction Hoses

## Hose Sets

| Part No | Description  |
|---------|--|
| 2125    | Hose set Ø 50/38 L = 7 m<br>Ø 2"/1.5" L = 23 ft            |
| 2126    | Hose set Ø 50/38 L = 7 m<br>Ø 2"/1.5" L = 23 ft antistatic |
| 2006    | Hose set Ø 38 L = 2 m<br>Ø 1.5" L = 6.5 ft                 |
| 2015    | Hose set Ø 38/1.5" L = 2 m/6,5ft                           |
| 2105    | Hose set Ø 38/1.5" L = 5 m/16ft**                          |

\*\* Standard suction hose, turnable, non removable connector.  
(Replacement to standard hose kit)

Standard suction hose, turnable  
intermediate sleeve 50/38

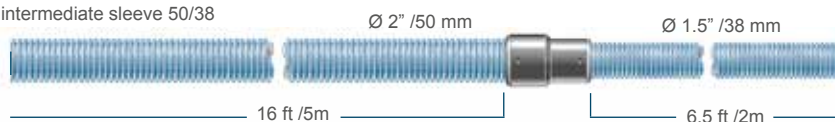

Antistatic suction hose, turnable  
intermediate sleeve 50/38

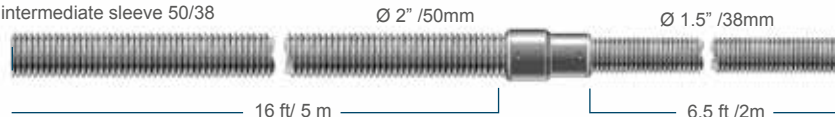

Standard suction hose, turnable  
intermediate sleeve 50/38



Standard suction hose, turnable  
intermediate sleeve 50/38

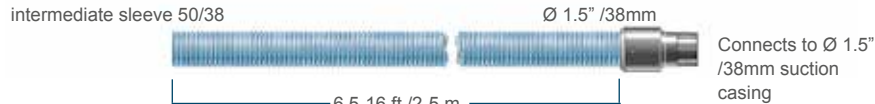

## Characteristics of Materials

| Description       | Dimension Ø inch/mm   | Part No | Colour | Material | Temp °F max/min/<br>Temp °C max/min | Antistatic | Abrasion<br>resistance | UV and zone<br>resistance | Resistance to<br>welding fume | Resistance to<br>solvent and oil |
|-------------------|-----------------------|---------|--------|----------|-------------------------------------|------------|------------------------|---------------------------|-------------------------------|----------------------------------|
| Coupling socket   | 3"/2"/76/50           | 2008*   | Black  | EPDM     | 284/-76/140/-60                     | Yes        | 2                      | 1                         | 2                             | 4                                |
|                   | 2"/2"/50/50           | 2107*   | Black  | EPDM     | 284/-76/140/-60                     | Yes        | 2                      | 1                         | 2                             | 4                                |
|                   | 2"/1.5"/50/38         | 2108*   | Black  | EPDM     | 284/-76/140/-60                     | Yes        | 2                      | 1                         | 2                             | 4                                |
|                   | 3"/2"/76/50 (PU)**    | 2161*   | Black  | EPDM     | 284/-76/140/-60                     | Yes        | 2                      | 1                         | 2                             | 4                                |
| Coupling socket   | 3"/2"/76/50           | 2162*   | Blue   | NBR      | 248/-76/120/-60                     | Yes        | 2                      | 3                         | 3                             | 2                                |
| Coupling socket   | 2"/2"/50/50           | 2129*   | Black  | PA12     | 284/-4/140/-20                      | Yes        | 1                      | 2                         | 3                             | 1                                |
|                   | 2"/2"/50/50 (PU)**    | 2158*   | Black  | PA12     | 284/-4/140/-20                      | Yes        | 1                      | 2                         | 3                             | 1                                |
|                   | 2"/1.5"/50/38 (PU)**  | 2157*   | Black  | PA12     | 284/-4/140/-20                      | Yes        | 1                      | 2                         | 3                             | 1                                |
|                   | 2"/1.5"/50/38         | 2128*   | Black  | PA12     | 284/-4/140/-20                      | Yes        | 1                      | 2                         | 3                             | 1                                |
|                   | 1.5"/1.25"/38/32      | 2133*   | Black  | PA12     | 284/-4/140/-20                      | Yes        | 1                      | 2                         | 3                             | 1                                |
|                   | 1.25"/1.25"/32/32     | 2171*   | Black  | PA12     | 284/-4/140/-20                      | Yes        | 1                      | 2                         | 3                             | 1                                |
| Connecting sleeve | 1.25"/1.5"/32/38      | 2132*   | Black  | PA12     | 284/-4/140/-20                      | Yes        | 1                      | 2                         | 3                             | 1                                |
|                   | 1.5"/1.5/38/38 (PU)** | 2159*   | Black  | PA12     | 284/-4/140/-20                      | Yes        | 1                      | 2                         | 3                             | 1                                |
|                   | 1.5"/1.5/38/38        | 2114*   | Black  | PA12     | 284/-4/140/-20                      | Yes        | 1                      | 2                         | 3                             | 1                                |
|                   | 2"/2"/50/50           | 2129*   | Black  | PA12     | 284/-4/140/-20                      | Yes        | 1                      | 2                         | 3                             | 1                                |
|                   | 1"/1"/25/25           | 2167*   | Black  | PA12     | 284/-4/140/-20                      | Yes        | 1                      | 2                         | 3                             | 1                                |
|                   | 1.5"/1.5/38/38        | 2115*   | Black  | PA12     | 284/-4/140/-20                      | Yes        | 1                      | 2                         | 3                             | 1                                |
| Connecting sleeve | 1"/1.5"/26/38         | 2109*   | Black  | EPDM     | 284/-76/140/-60                     | Yes        | 2                      | 1                         | 2                             | 4                                |
|                   | 1"/1.25"/26/32        | 2110*   | Black  | EPDM     | 284/-76/140/-60                     | Yes        | 2                      | 1                         | 2                             | 4                                |
|                   | .7"/1.25"/17/32       | 2106*   | Black  | EPDM     | 284/-76/140/-60                     | Yes        | 2                      | 1                         | 2                             | 4                                |
| Connecting sleeve | 1.25"/1.25"/32/32     | 2116    | Grey   | PE       | 45/-45                              | No         | 1                      | 2                         | 3                             | 1                                |
|                   | 1"/1"/25/25           | 2117    | Grey   | PE       | 45/-45                              | No         | 1                      | 2                         | 3                             | 1                                |
| Inter, sleeves    | 2"/1.5"/50/38         | 2131*   | Black  | PA12     | 284/-4/140/-20                      | Yes        | 1                      | 2                         | 3                             | 1                                |
|                   | 2"/1.5"/50/38 (PU)**  | 2160*   | Black  | PA12     | 284/-4/140/-20                      | Yes        | 1                      | 2                         | 3                             | 1                                |
| Inter, sleeves    | 3"/2"/76/50           | 2100*   | Black  | EPDM     | 284/-76/140/-60                     | Yes        | 2                      | 1                         | 2                             | 4                                |
|                   | 2"/1.5"/50/38         | 2120*   | Black  | EPDM     | 284/-76/140/-60                     | Yes        | 2                      | 1                         | 2                             | 4                                |
|                   | 1.5"/1.25"/38/32      | 2121*   | Black  | EPDM     | 284/-76/140/-60                     | Yes        | 2                      | 1                         | 2                             | 4                                |
|                   | 1.25"/1"/32/25        | 2101*   | Black  | EPDM     | 284/-76/140/-60                     | Yes        | 2                      | 1                         | 2                             | 4                                |
| Hose connector    | 2"/50                 | 2403    | Grey   | PE       | 45/-45                              | No         | 2                      | 2                         | 3                             | 3                                |
|                   | 1.5"/38               | 2118    | Grey   | PE       | 45/-45                              | No         | 2                      | 2                         | 3                             | 3                                |
|                   | 1.25"/32              | 2119    | Grey   | PE       | 45/-45                              | No         | 2                      | 2                         | 3                             | 3                                |
| Hose connector    | 2"/50                 | 2170*   | Black  | PA12     | 284/-4/140/-20                      | Yes        | 1                      | 2                         | 3                             | 1                                |
|                   | 1.5"/38               | 2169*   | Black  | PA12     | 284/-4/140/-20                      | Yes        | 1                      | 2                         | 3                             | 1                                |
|                   | 1.25"/32              | 2168*   | Black  | PA12     | 284/-4/140/-20                      | Yes        | 1                      | 2                         | 3                             | 1                                |

\* Antistatic is defined as having a conductivity of < 10<sup>6</sup> Ω

To order an antistatic ESD version, add the letter E to the end of the part no.

\*\* The wire helix must be bared and left in contact with conductive material

### Resistance Scale

- 1 Excellent
- 2 Good
- 3 Limited
- 4 Poor



## Capture Dust at the Source.

The suction casing is the key to an effective source extraction system. It must be lightweight and well designed, but it should also capture the dust efficiently and effectively.

Here we present our suction casings for the most common power tool types and manufacturers.



# Find the Right Suction Casing

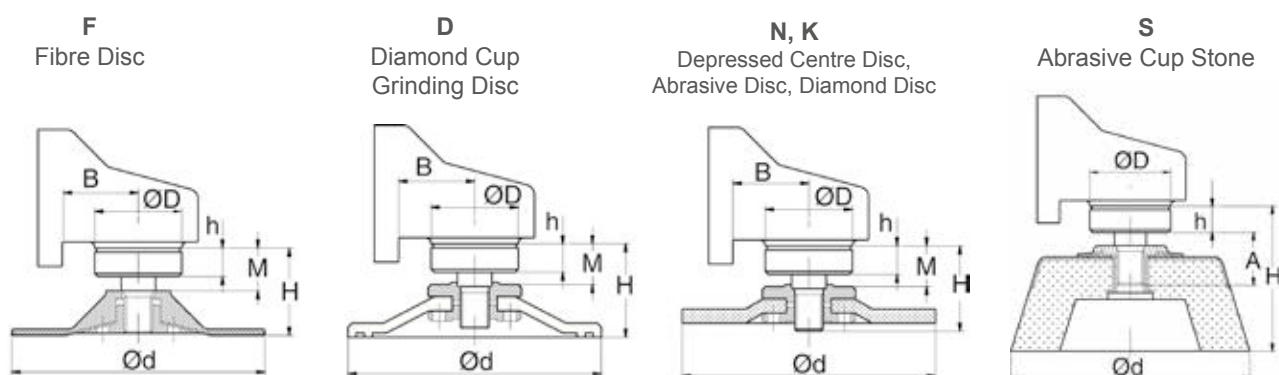

| Machine |   | Make |   |   | Type |   |
|---------|---|------|---|---|------|---|
| D       | d | H    | h | A | B    | M |
|         |   |      |   |   |      |   |

## Legend

- F Fibre disc
- D Diamond cup grinding disc
- N Depressed centre disc
- K Abrasive disc, diamond disc
- S Abrasive cup stone

If you cannot find the suction casing you are looking for, contact your sales representative for pricing information regarding a product tailored to your specific needs.

All suction cases should always be connected to a dust extractor while operating.

# Suction Casings

## Suction Casing Kit for Fibre Discs (F)

1

Measure the diameter of the disc.



2

Measure the diameter of the mounting collar on the machine - ØD and the height of the machine - H.

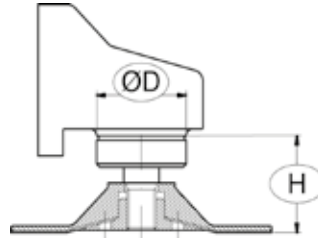

3



### Technical data

| Disc diameter    | Ø D                                 | H                 | Connection, Ø | Part No. |
|------------------|-------------------------------------|-------------------|---------------|----------|
| 1½–3" (38–75 mm) | 1.1"/27                             | *                 | 1.25"/32 mm   | 6833*    |
| 4" (100 mm)      | 1.6–1.9"/40–49                      | 1.5–1.7"/39–44 mm | 1.25"/32 mm   | 6670     |
| 4½" (115 mm)     | 1.6–1.9"/40–49                      | 1.5–1.9"/39–48 mm | 1.25"/32 mm   | 6671     |
| 5" (125 mm)      | 1.6–1.9"/40–49                      | 1.5–1.9"/39–48 mm | 1.25"/32 mm   | 6672     |
| 5" (125 mm)      | 2"/50                               | 1.5–2.1"/38–61 mm | 1.25"/32 mm   | 6673     |
| 7" (175 mm)      | 2.1–2.4"/54–61                      | 2–2.3"/50–59 mm   | 1.5"/38 mm    | 6674     |
| 7" (175 mm)      | 2.4–2.6" & 2.9–3"<br>/62–65 & 74–77 | 2–2.9"/50–73 mm   | 1.5"/38 mm    | 6675     |

\*\* Some Hitachi machines have a Ø40 mm /1.6" conical neck. With these, it is necessary to buy an aluminium ring (part no 6270). When fitted on the machine, this aluminium ring enlarges the ØD of the machine to 50 mm /1.9" – therefore choose the 5" N, K suction casing kit – part no 6678.





# Suction Casings

## Suction Casing Kit for Diamond Cup Grinding Discs (D)

1

Measure the diameter of the disc.



2

Measure the diameter of the mounting collar on the machine - ØD and the height of the machine - H.

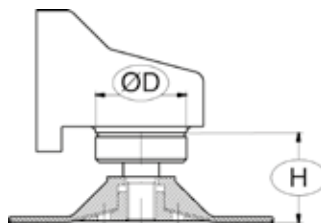

3



### Technical data

| Disc diameter | Ø D                                    | H                  | Connection, Ø | Part No |
|---------------|--|--------------------|---------------|---------|
| 4½" (115 mm)  | 1.6"–1.9"/40–49 mm                     | 1.9"–2.1"/49–54 mm | 1.25"/32 mm   | 6681    |
| 5" (125 mm)   | 1.6"–1.9"/40–49 mm                     | 1.9"–2.8"/49–70 mm | 1.25"/32 mm   | 6682    |
| 5" (125 mm)   | 2"/50 mm                               | 1.5"–2.4"/38–61 mm | 1.25"/32 mm   | 6673    |
| 7" (175 mm)   | 2.1"–2.4"/54–61 mm                     | 2.5"–2.8"/63–72 mm | 1.5"/38 mm    | 6683    |
| 7" (175 mm)   | 2.4"–2.6" & 2.9"–3" / 62–65 & 74–77 mm | 2.5"–3.4"/63–86 mm | 1.5"/38 mm    | 6684    |

All suction cases should always be connected to a dust extractor while operating.





# Suction Casings

## Suction Casing Kit for Depressed Centre Discs, Abrasive Discs and Diamond Discs (N, K)

1

Measure the diameter of the disc.



Note: Max. thickness of disc = 18 mm.

2

Measure the diameter of the mounting collar on the machine  $\varnothing D$  and the height of the machine - H.

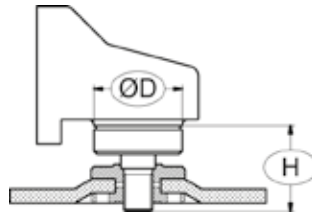

3



### Technical data

| Disc diameter          | $\varnothing D$    | H                  | Connection, $\varnothing$ | Part No. |
|------------------------|--------------------|--------------------|---------------------------|----------|
| 4 1/2" (115 mm)        | 1.6"–1.9"/40–49 mm | 1.2"–1.8"/31–46 mm | 1.25"/32                  | 6676     |
| 5" (125 mm)            | 1.6"–1.8"/40–45 mm | 1.2"–1.8"/31–46 mm | 1.25"/32                  | 6677**   |
| 5" (125 mm)            | 1.8"–2.1"/46–53    | 1.2"–1.8"/31–46 mm | 1.25"/32                  | 6678     |
| 7" (180 mm)            | Tailor-made        | Tailor-made        | 1.5"/38                   | *        |
| 9"                     | 4.4"/112 mm        | 1.5"/37 mm         | 1.5"/38                   | 6221*    |
| 9"                     | 2.7"/68 mm         | 2"/51 mm           | 1.5"/38                   | 6202*    |
| 9"                     | 2.9"/74 mm         | 2.1"/54 mm         | 1.5"/38                   | 6302*    |
| 9"                     | 2.9"/74 mm         | 1.5"/37 mm         | 1.5"/38                   | 6349*    |
| 9"                     | 2"/50 mm           | 1.9"/47 mm         | 1.5"/38                   | 6500*    |
| 9"                     | 2.4"/62 mm         | 2.1"/54 mm         | 1.5"/38                   | 6416*    |
| 9"                     | 2.4"/62 mm         | 2"/50 mm           | 1.5"/38                   | 6438*    |
| 9"                     | 2.4"/62 mm         | 1.9"/48 mm         | 1.5"/38                   | 6555*    |
| 9"                     | 2.6"/65 mm         | 1.6"/40 mm         | 1.5"/38                   | 6842*    |
| 9"                     | 2.5"/64 mm         | 2"/52 mm           | 1.5"/38                   | 6427*    |
| 9"                     | 2.3"/58 mm         | 2.1"/54 mm         | 1.5"/38                   | 6537*    |
| Georges Renault KL 365 | 9"                 | 2.3"/59 mm         | 1.5"/38 mm                | 6388*    |

\* With the clamping rings welded on the suction casings.

\*\* Some Hitachi machines have a  $\varnothing 40$  mm conical neck. With these, it is necessary to buy an aluminium ring (part no 6270). When fitted on the machine, this aluminium ring enlarges the  $\varnothing D$  of the machine to 50 mm – therefore choose the 5" N, K suction casing kit – part no 6678.

### Connection $\varnothing$

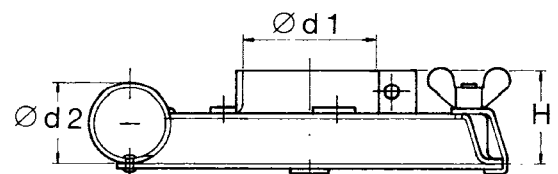

# Suction Casings

## Suction Casing Kit for Abrasive Cup Stone (S)

1

Measure the diameter of the disc.



2

Measure the diameter of the mounting collar on the machine  $\varnothing D$  and the height of the machine - H.

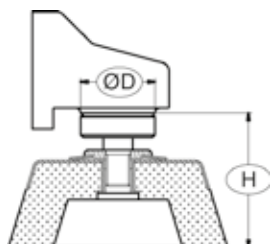

3



### Technical data

| Disc diameter | $\varnothing D$  | H                 | Connection, $\varnothing$ | Part No |
|---------------|------------------|-------------------|---------------------------|---------|
| 5" (125 mm)   | 1.9-3"/ 50-77 mm | 1.8-3.2"/46-81 mm | 1.5"/38 mm                | 6680    |
| 6" (150 mm)   | 74-77 mm         | 46-81 mm          | 1.5"/38 mm                | 6023    |

## Reciprocating Saw – Suction casings C



All suction cases should always be connected to a dust extractor while operating.



### Technical data

| Machine model   | Connection, $\varnothing$ (mm) | Part No |
|---|--------------------------------|---------|
| Atlas Copco SSE 1000 X/SQ/, Milwaukee 65xx-xx (Sawzall) | 1.5" /32                       | 6290    |
| Milwaukee 6378  | 1.5" /32                       | 6269    |

# Suction Casings

## Suction Casing for Hammer Drills, Chisels and Breakers



Part No 7033 Chrome steel hand pipe Ø50



### Suction casings B, H, M, L

| No | Part No     | Connection tool Ø              | Hose connection Ø | Height       |
|----|-------------|--------------------------------|-------------------|--------------|
| 1  | 6621        | 1.89"/48 mm                    | 1.5"/38 mm        | 6.22"/158 mm |
| 2  | 6622        | 1.69"/43 mm                    | 1.5"/38 mm        | 6.22"/158 mm |
| 3  | 6077        | 1.26"/32 mm                    | 1.26"/32 mm       | 4.4"/112 mm  |
| 4  | 6078        | 2.4"/61 mm                     | 1.5"/38 mm        | 7"/178 mm    |
| 5  | 6001 (7033) | -                              | 2"/50 mm          | 3.9"/100 mm  |
| 6  | 6130        | Bellow for 6078, 6621 and 6622 |                   |              |

Part No 6622 and 6077 are suitable for small chisel hammers.



### Model-specific suction casings

| Part No | Model                     | Hose connection Ø |
|---------|---------------------------|-------------------|
| 6229    | Atlas Copco RRD 37/RRD 57 | 1.5"/38 mm        |
| 6152    | Atlas Copco BBD 11/RRC 73 | 1.5"/38 mm        |



# Suction Casings

## Spare Parts for Suction Casings

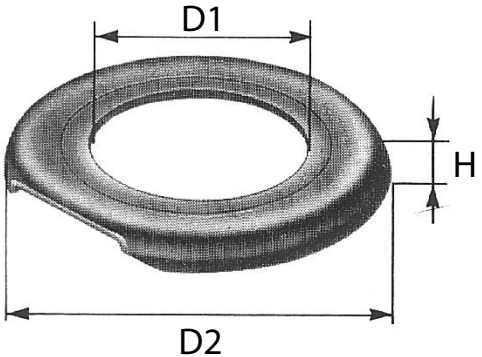
|    | Description                                   | Dimension   |   |   |   | Part No.   |
|---|---|---|---|---|---|--|
|   |   |   | D1<br>in/mm   | D2<br>in/mm   | H<br>in/mm  |  |
|   | Plastic ring for saucer grinder               | 5 S<br>6 S  | 4.8"/121<br>5.8"/147  | 5.5"/139<br>6.5"/164  | 2"/50<br>2"/50  | 6003<br>6004   |
|   | Rubber collar for fibre disc (F)              | 1 ½ F<br>2 F<br>3 F<br>4 F<br>4 ½ F<br>4 ½ F<br>5 F | 1.5"/39<br>1.5"/39<br>1.5"/39<br>2.8"/72<br>2.8"/72<br>2.8"/72<br>2.8"/72 | 2.3"/59<br>2.7"/69<br>3.7"/95<br>4.6"/117<br>5.3"/135<br>5.3"/135<br>5.7"/145 | 0.9"/23<br>0.9"/23<br>1"/25<br>0.5"/13<br>0.5"/13<br>0.9"/23<br>0.5"/13 | 6314<br>6313<br>6312<br>6182<br>6181<br>618100<br>6195 |
|  | Rubber collar for fibre disc (F)              | 5 F   | 3.8"/96   | 5.9"/150  | 0.6"/15   | 6006   |
|  | Rubber collar for oscillating sanding machine | 5 O<br>6 O  | 2.8"/72<br>3.8"/96  | 5.7"/145<br>6.7"/170  | 1.5"/38<br>1.1"/28  | 6212<br>6180   |
|  | Rubber collar for fibre disc (F)              | 7 F<br>7 F<br>8 F<br>9 F                            | 4.4"/112<br>4.4"/112<br>4.4"/112<br>4.5"/113                              | 7.7"/196<br>7.7"/196<br>8.7"/221<br>10"/250                                   | 7"/19<br>1.4"/35<br>1.6"/41<br>1.25"/32                                 | 6002<br>6034<br>6211<br>6039                           |

# Choose the Right Filter

**Pleated design** increases the filtering surface. For filtering to be effective without affecting user performance, the air velocity through the filter must be maintained but without overloading the volume capacity of the filter media. Suitable filter loadings vary with the material being extracted. Suitable filter loading, measured in  $\text{m}^3/\text{hr}$  per  $\text{m}^2$  of filter area, for concrete dust is for example, a maximum of  $120\text{m}^3/\text{hr}$  per  $\text{m}^2$ , while welding fume is only  $60\text{m}^3/\text{hr}$  per  $\text{m}^2$  as it exerts a higher filter loading or simply put, it will block the filters more quickly. This is always considered in Dustcontrol's design criteria.

Our dust extractor separates dust in three stages:

1. Large particles are separated dynamically in the **Cyclone**.
2. Filtration then takes place in the pleated **Fine Filter**.
3. Followed by a pleated **Microfilter** HEPA H13.

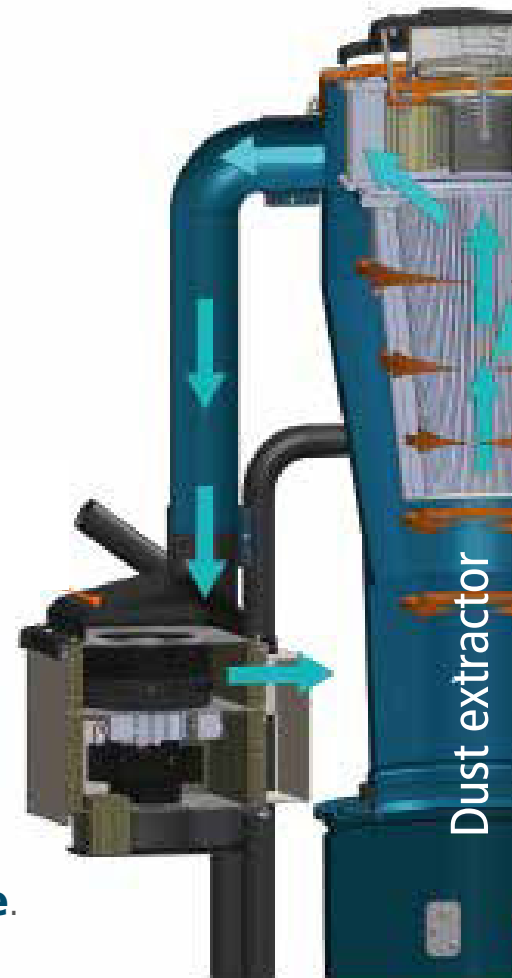

**The Fine Filter.** This filter is designed to capture the small particles that are not captured in the pre-separator or cyclone.



#### Cellulose Fine Filter

A high-quality, standard filter with high filtration efficiency. Epoxy-treated for improved resistance to humidity and other elements. It is pleated around a support cylinder.



#### Polyester Fine Filter

A high-quality filter resistant to most substances. Perfect for use in wet environments such as mechanical workshops in which cutting fluids etc. is used. Slightly smoother surface than the cellulose filter, enabling more efficient cleaning and a longer service life. The filter is washable.



#### PTFE Fine Filter

The polyester filter is treated with PTFE, meaning that the filter coating can easily be separated from the surface. This type of filter is suitable for use in applications such as floor grinding. The filter is washable.

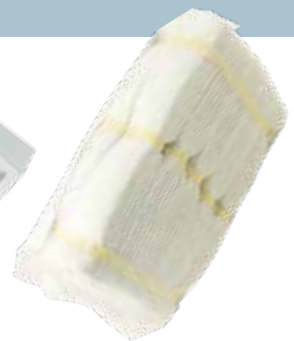

**A Pre-Filter** is a basic filter used with air cleaners in order to capture large particles and relieve the loading on the HEPA filter. The pre-filter is designed as a pleated filter in cassette or textile form. It is disposable. Each Pre-Filter filter is individually tested for level G4 compliance.

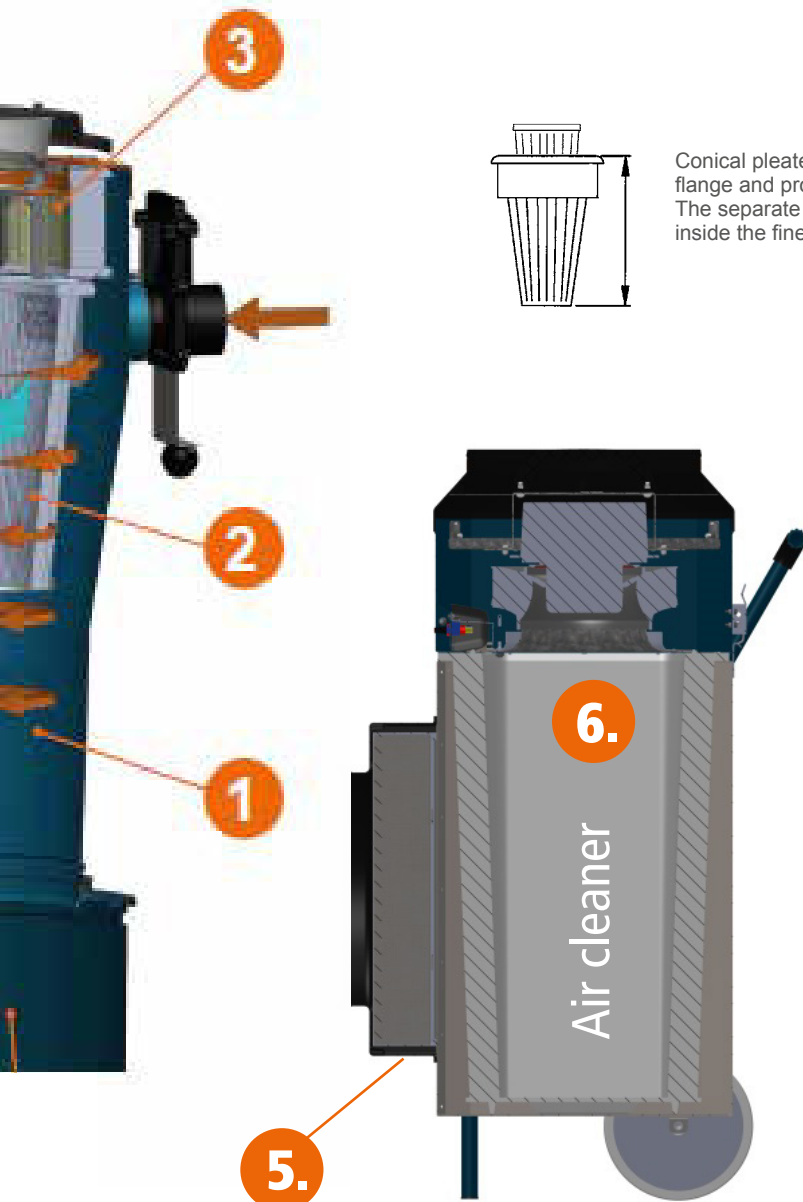

Air cleaner

Our Air cleaners separate dust in two stages:

4. Large particles are separated by the **Carpet Pre-filter**, or a
5. **Pre-filter cartridge**,
6. followed by a pleated **HEPA H13 Microfilter**

**Microfilter, HEPA filter, Absolute Filter** goes by many names, and has a filtration efficiency of 99.995%.



#### A HEPA Filter

The HEPA filter is assembled from a very fine-meshed fibreglass textile with extremely deep-acting properties. One or two layers of e.g. cellulose may be added to improve rigidity.

Each HEPA filter is individually tested for level H13 compliance. The test report can be obtained on request.



Dustcontrol's HEPA filters comply with the requirements for H-class dust extractors. The HEPA filter should be replaced when it becomes saturated.

All Dustcontrol's dust extractors and air cleaners, have a separate HEPA H13 filter installed after the fine filter or pre-filter. The filter systems in all Dustcontrol dust extractors are built to comply with the stringent IEC machine classification H.



# Filters

## DC 1800, DC 1800 XL, DC 2900, DC 3800 Wood Shavings Extractor

| Part No | Description   | Construction                    | Material                 | Area ft <sup>2</sup> /m <sup>2</sup> | Classification           | Max temp   |
|---------|---|---------------------------------|--------------------------|--------------------------------------|--------------------------|------------|
| 42029   | Fine filter   | Pleated around support cylinder | Cellulose, epoxy-treated | 16.2 /1.5                            | IEC EN 60335-2-69 Part 1 | 176°F/80°C |
| 42029ST | Fine filter x 48  |                                 | Cellulose                |                                      |                          |            |
| 42028   | Fine filter   | Pleated                         | Polyester                | 16.2 /1.5                            | IEC EN 60335-2-69 Part 1 | 176°F/80°C |
| 42027   | HEPA filter   | Pleated                         | Cellulose, fibreglass    | 9.1 /0.85                            | HEPA H13 EN 1822-1       | 176°F/80°C |
| 40479   | Combi-filter (Fine filter + HEPA filter), (GS Asbestos) | Pleated                         | Cellulose, epoxy-treated | 16.2 /1.5                            | HEPA H13 EN 1822-1       | 176°F/80°C |

## DC Tromb 400

| Part No | Description | Construction                    | Material                 | Area ft <sup>2</sup> /m <sup>2</sup> | Classification           | Max temp     |
|---------|-------------|---------------------------------|--------------------------|--------------------------------------|--------------------------|--------------|
| 44017   | Fine filter | Pleated around support cylinder | Polyester                | 27 /2.5                              | IEC EN 60335-2-69 Part 1 | 176°F/80°C   |
| 44043   | Fine filter | Pleated around support cylinder | Cellulose, epoxy-treated | 27 /2.5                              | IEC EN 60335-2-69 Part 1 | 176°F/80°C   |
| 44016   | HEPA filter | Pleated                         | Cellulose, fibreglass    | 23.7 /2.2                            | HEPA H13 EN 1822-1       | 176°F/80°C   |
| 44213   | Fine filter | Pleated around support cylinder | Polyester, PTFE          | 27 /2.5                              | IEC EN 60335-2-69 Part 1 | 266°F /130°C |

## DC 3900, DC 3900 Twin, DC 4000 PCB

| Part No | Description       | Construction                    | Material                 | Area ft <sup>2</sup> /m <sup>2</sup> | Classification           | Max temp   |
|---------|-------------------|---------------------------------|--------------------------|--------------------------------------|--------------------------|------------|
| 42026   | Fine filter       | Pleated around support cylinder | Cellulose, epoxy-treated | 19.4/ 1.8                            | IEC EN 60335-2-69 Part 1 | 176°F/80°C |
| 42026ST | Fine filter x 24  |                                 | Cellulose                |                                      |                          |            |
| 42025   | Fine filter       | Pleated                         | Polyester                | 19.4/ 1.8                            | IEC EN 60335-2-69 Part 1 | 176°F/80°C |
| 42025ST | Fine filter x 24  |                                 | Polyester                |                                      |                          |            |
| 42465   | Fine filter, PTFE | Pleated around support cylinder | Polyester, PTFE          | 19.4/ 1.8                            | IEC EN 60335-2-69 Part 1 | 176°F/80°C |
| 42024   | HEPA filter       | Pleated                         | Cellulose, fibreglass    | 16/ 1.5                              | HEPA H13 EN 1822-1       | 176°F/80°C |
| 42398   | Fine filter       | Pleated around support cylinder | Polyester                | 19.4/ 1.8                            | IEC EN 60335-2-69 Part 1 | 176°F/80°C |
| 4202501 | Fine filter       |                                 | Antistatic               | 16.2 /1.5                            |                          | 176°F/80°C |

## DC 5900 & DC Storm

| Part No | Description                              | Construction                    | Material              | Area ft <sup>2</sup> /m <sup>2</sup> | Classification           | Max temp     |
|---------|--|---------------------------------|-----------------------|--------------------------------------|--------------------------|--------------|
| 429203  | Fine filter, PTFE                        | Pleated around support cylinder | Polyester, PTFE       | 53.8/ 5.0                            | IEC EN 60335-2-69 Part 1 | 266°F /130°C |
| 429204  | Fine filter                              | Pleated around support cylinder | Polyester             | 53.8/ 5.0                            | IEC EN 60335-2-69 Part 1 | 266°F /130°C |
| 4292    | Fine filter                              | Pleated around support cylinder | Polyester             | 90.4/ 8.4                            | IEC EN 60335-2-69 Part 1 | 266°F /130°C |
| 42869   | HEPA filter, DC Storm 500 (DC 5900 4 kW) | Pleated around support cylinder | Cellulose, fibreglass | 29/ 2.7                              | HEPA H13 EN 1822-1       | 176°F/80°C   |
| 42807   | HEPA filter, DC Storm 600/700/5900       | Pleated                         | Cellulose, fibreglass | 39.8/ 3.7                            | HEPA H13 EN 1822-1       | 176°F/80°C   |
| 44212   | Fine filter, DC Storm 600/700/5900       | Pleated around support cylinder | Polyester             | 53.8/ 5.0                            | IEC EN 60335-2-69 Part 1 | 266°F /130°C |
| 44081   | Fine filter, PTFE                        | Pleated around support cylinder | Polyester, PTFE       | 53.8/ 5.0                            | IEC EN 60335-2-69 Part 1 | 266°F /130°C |

## DC AirCube

| Part No | Description        | Construction                    | Material              | Area ft <sup>2</sup> /m <sup>2</sup> | Classification     | Max temp    |
|---------|--------------------|---------------------------------|-----------------------|--------------------------------------|--------------------|-------------|
| 42896   | HEPA filter AC2000 | Pleated around support cylinder | Cellulose, fibreglass | 107.6/ 10                            | HEPA H13 EN 1822-1 | 122°F /50°C |
| 42917   | Pre-filter AC2000  | Cartridge                       | Polyester             | 53.8/ 0.5                            | G4                 | 122°F /50°C |
| 42690   | Pre-filter AC500   | Pleated carpet                  | Polyester             | 2/ 0.18                              | G4                 | 176°F/80°C  |
| 42692   | HEPA filter AC500  | Pleated                         | Cellulose, fibreglass | 45/ 4.2                              | HEPA H13 EN 1822-1 | 176°F/80°C  |
| 42918   | Pre-filter AC1200  | Cartridge                       | Polyester             | 4.3/ 0.4                             | G4                 | 176°F/80°C  |
| 42940   | HEPA filter AC1200 | Pleated                         | Cellulose, fibreglass | 59/ 5.5                              | HEPA H13 EN 1822-1 | 176°F/80°C  |

## Filters for earlier models

### DC 2500, DC 2500 Twin

| Part No | Description                             | Construction                    | Material              | Area ft <sup>2</sup> /m <sup>2</sup> | Classification           | Max temp     |
|---------|---|---------------------------------|-----------------------|--------------------------------------|--------------------------|--------------|
| 4889    | Fine filter                             | Pleated                         | Polyester             | 15 /1.4                              | IEC EN 60335-2-69 Part 1 | 266°F /130°C |
| 404901  | Fine filter                             | Pleated around support cylinder | Cellulose             | 16.2 /1.5                            | IEC EN 60335-2-69 Part 1 | 158°F /70°C  |
| 4821    | HEPA filter K                           | Pleated                         | Cellulose, fibreglass | 16.2 /1.5                            | HEPA H13 EN 1822-1       | 158°F /70°C  |
| 4133    | HEPA filter (fitted in the fine filter) | Pleated around support cylinder | Cellulose, fibreglass | 5.4 /0.5                             | HEPA H13 EN 1822-1       | 176°F/80°C   |

### DC 2700c, DC 2800c

Machines from serial number 2527595 can be equipped with the new, separate HEPA filter (Part No 42027). Older models should be equipped with a HEPA combi-filter.

| Part No | Description                             | Construction                    | Material                 | Area ft <sup>2</sup> /m <sup>2</sup> | Classification           | Max temp     |
|---------|---|---------------------------------|--------------------------|--------------------------------------|--------------------------|--------------|
| 4889    | Fine filter                             | Pleated                         | Polyester                | 15 /1.4                              | IEC EN 60335-2-69 Part 1 | 266°F /130°C |
| 404901  | Fine filter                             | Pleated around support cylinder | Cellulose                | 16.2 /1.5                            | IEC EN 60335-2-69 Part 1 | 158°F /70°C  |
| 4821    | HEPA filter K                           | Pleated                         | Cellulose, fibreglass    | 16.2 /1.5                            | HEPA H13 EN 1822-1       | 158°F /70°C  |
| 4133    | HEPA filter (fitted in the fine filter) | Pleated around support cylinder | Cellulose, fibreglass    | 5.4 /0.5                             | HEPA H13 EN 1822-1       | 176°F/80°C   |
| 42027   | HEPA filter                             | Pleated                         | Cellulose, fibreglass    | 9.1 /0.85                            | HEPA H13 EN 1822-1       | 176°F/80°C   |
| 42028   | Polyester filter                        | Pleated                         | Polyester                | 16.2 /1.5                            | IEC EN 60335-2-69 Part 1 | 176°F/80°C   |
| 42029   | Fine filter                             | Pleated around support cylinder | Cellulose, epoxy-treated | 16.2 /1.5                            | IEC EN 60335-2-69 Part 1 | 176°F/80°C   |

### DC 3700c

| Part No | Description | Construction                    | Material                 | Area ft <sup>2</sup> /m <sup>2</sup> | Classification           | Max temp   |
|---------|-------------|---------------------------------|--------------------------|--------------------------------------|--------------------------|------------|
| 42026   | Fine filter | Pleated around support cylinder | Cellulose, epoxy-treated | 19.4 /1.8                            | IEC EN 60335-2-69 Part 1 | 176°F/80°C |
| 42025   | Fine filter | Pleated                         | Polyester                | 19.4 /1.8                            | IEC EN 60335-2-69 Part 1 | 176°F/80°C |

# Filters for earlier models

## DC 3500, DC 3500 TR, DC 5500

| Part No | Description   | Construction                    | Material              | Area ft <sup>2</sup> /m <sup>2</sup> | Classification           | Max temp    |
|---------|---|---------------------------------|-----------------------|--------------------------------------|--------------------------|-------------|
| 408801  | Fine filter   | Pleated                         | Polyester             | 17 /1.6                              | IEC EN 60335-2-69 Part 1 | 176°F/80°C  |
| 408803  | Fine filter   | Pleated                         | Cellulose             | 17 /1.6                              | IEC EN 60335-2-69 Part 1 | 176°F/80°C  |
| 4821    | HEPA filter, DC 3500 TR   | Pleated                         | Cellulose, fibreglass | 16.2 /1.5                            | HEPA H13 EN 1822-1       | 158°F /70°C |
| 4366    | HEPA filter, DC 3500 (installed on exhaust)                     | Pleated around support cylinder | Cellulose, fibreglass | 12.9 /1.2                            | HEPA H13 EN 1822-1       | 176°F/80°C  |
| 4422    | HEPA filter, DC 5500 5 kW, 9.2 kW S (installed under top cover) | Pleated around support cylinder | Cellulose, fibreglass | 26.9 /2.5                            | HEPA H13 EN 1822-1       | 176°F/80°C  |
| 4017    | HEPA filter, DC 5500 9.2 kW P (installed on exhaust)            | Pleated                         | Cellulose, fibreglass | 30 /2.8                              | HEPA H13 EN 1822-1       | 176°F/80°C  |

## DC 5700c, DC 5800a/c 5 kW, DC 5800a/c PTFE

| Part No | Description   | Construction                    | Material              | Area ft <sup>2</sup> /m <sup>2</sup> | Classification           | Max temp     |
|---------|---|---------------------------------|-----------------------|--------------------------------------|--------------------------|--------------|
| 4917    | Combi-filter DC 3500i (Fine filter + HEPA H13 filter)           | Pleated                         | Cellulose, fibreglass | 16.2 /1.5                            | HEPA H13 EN 1822-1       | 176°F/80°C   |
| 4422    | HEPA filter, DC 5700 5 kW, 9.2 kW S (installed under top cover) | Pleated around support cylinder | Cellulose, fibreglass | 26.9 /2.5                            | HEPA H13 EN 1822-1       | 176°F/80°C   |
| 4017    | HEPA filter, DC 5700 9.2 kW P (installed on exhaust)            | Pleated                         | Cellulose, fibreglass | 30 /2.8                              | HEPA H13 EN 1822-1       | 176°F/80°C   |
| 4292    | Fine filter, DC 5800 11kWp                                      | Pleated around support cylinder | Polyester             | 90.4/ 8.4                            | IEC EN 60335-2-69 Part 1 | 266°F /130°C |
| 429204  | Fine filter, DC 5800 5 kWp                                      | Pleated around support cylinder | Polyester             | 53.8/ 5.0                            | IEC EN 60335-2-69 Part 1 | 266°F /130°C |

## Air Cleaners, DC 380, DC 1500, DC AirCube

| Part No | Description                   | Construction            | Material   | Area ft <sup>2</sup> /m <sup>2</sup> | Classification           | Max temp     |
|---------|-------------------------------|-------------------------|------------|--------------------------------------|--------------------------|--------------|
| 4080    | Pre-filter, DC 380/DC AirCube | Carpet                  | Polyester  | 1 /0.1                               | IEC EN 60335-2-69 Part 1 | 212°F /100°C |
| 4669    | Pre-filter, DC 1500           | Carpet                  | Polyester  | 3.2 /0.3                             | IEC EN 60335-2-69 Part 1 | 212°F /100°C |
| 42136   | HEPA filter, DC AirCube       | Pleated HEPA filter box | Fibreglass | 55.9/5.2                             | EN 1822-1, HEPA H13      | 176°F/80°C   |

## DC 3800a/c, DC 3800c Turbo, DC 3800c Twin, DC 3800 TR S

| Part No | Description           | Construction                    | Material                 | Area ft <sup>2</sup> /m <sup>2</sup> | Classification           | Max temp   |
|---------|-----------------------|---------------------------------|--------------------------|--------------------------------------|--------------------------|------------|
| 42026   | Fine filter           | Pleated around support cylinder | Cellulose, epoxy-treated | 19.4 /1.8                            | IEC EN 60335-2-69 Part 1 | 176°F/80°C |
| 42026ST | Fine filter x 24      |                                 | Cellulose                |                                      |                          |            |
| 42025   | Fine filter           | Pleated                         | Polyester                | 19.4 /1.8                            | IEC EN 60335-2-69 Part 1 | 176°F/80°C |
| 42025ST | Fine filter x 24      |                                 | Polyester                |                                      |                          |            |
| 42465   | Fine filter, PTFE     | Pleated around support cylinder | Polyester, PTFE          | 19.4 /1.8                            | IEC EN 60335-2-69 Part 1 | 176°F/80°C |
| 42024   | HEPA filter           | Pleated                         | Cellulose, fibreglass    | 16.2 /1.5                            | HEPA H13 EN 1822-1       | 176°F/80°C |
| 42398   | Fine filter, grounded | Pleated around support cylinder | Polyester                | 19.4 /1.8                            | IEC EN 60335-2-69 Part 1 | 176°F/80°C |
| 4202501 | Fine filter           |                                 | Antistatic               | 16.2 /1.5                            |                          | 176°F/80°C |



# Plastic Bags

| Machine                         | Standard          | Antistatic/ESD | Volume (gal/litre) | Size (in/mm)                |
|---------------------------------|-------------------|----------------|--------------------|-----------------------------|
| DC 1800                         | 42291*            | 42951****      | 4 /20              | 21.7"x21.7" /550 x 550 mm   |
| DC 2900c                        | 42702*            |                | 5 /20              | 17"x 21.7" /440 x 550 mm    |
| DC 2800H Asbestos               | 42285****         | 42384****      | 10.5 /40           | 14"x27.5" /360 x 700 mm     |
| DC 3800H Asbestos               | 42285****         | 42384****      | 10.5 /40           | 14"x27.5" /360 x 700 mm     |
| DC 3900c                        | 43619*            | 42384****      | 10.5 /40           | 19.7"x33.5" /500 x 850 mm   |
| DC 3900L                        | 432177 longopac** |                | -                  | 72 ft /22 m                 |
| DC 3900c Twin                   | 43619*            | 42384****      | 10.5 /40           | 19.7"x33.5" /500 x 850 mm   |
| DC 3900L Twin                   | 432177 longopac** |                | -                  | 72 ft /22 m                 |
| DC 3900L Twin                   | 43619*            | 42384****      | 10.5 /40           | 19.7"x33.5" /500 x 850 mm   |
| DC 3900c Turbo                  | 43619*            | 42384****      | 10.5 /40           | 19.7"x33.5" /500 x 850 mm   |
| DC 3900c Twin Turbo             | 43619*            | 42384****      | 10.5 /40           | 19.7"x33.5" /500 x 850 mm   |
| DC Tromb 400c                   | 43619*            | 42384****      | 10.5 /40           | 19.7"x33.5" /500 x 850 mm   |
| DC Tromb 400L                   | 432177 longopac** |                | -                  | 72 ft /22 m                 |
| DC 3800 Wood Shavings Extractor | 4714***           |                | 23 /90             | 27.5"x43.3" /700 x 1100 mm  |
| DC 4000 PCB                     | 43619*            |                | 5 /40              | 14"x27.5" /360 x 700 mm     |
| DC 5900c/DC Storm c             | 46145*            |                | 15.5 /60           | 25.2"x39.4" /640 x 1000 mm  |
| DC 5900L/DC Storm L             | 44077 longopac    |                | -                  | 82 ft /25 m                 |
|                                 |                   |                |                    |                             |
| <b>Filter bag, Wet-Vac</b>      |                   |                |                    |                             |
| DC 50W                          | 42190             |                |                    |                             |
| DC 75W                          | 42190             |                |                    |                             |
|                                 |                   |                |                    |                             |
| <b>Pre-Separators</b>           |                   |                |                    |                             |
| DCF Storm c                     | 46145*            |                | 15.5 /60           | 25.2"x39.4" /640 x 1000 mm  |
| DCF Storm L                     | 44077 longopac    |                | -                  | 82 ft /25 m                 |
| DCF 2800c                       | 42702*            |                | 5 /20              | 17"x 21.7" /440 x 550 mm    |
| DCF 3900c                       | 43619*            |                | 10.5 /40           | 19.7"x33.5" /500 x 850 mm   |
| DCF 3900L                       | 432177 longopac** |                | -                  | 72 ft /22 m x 1             |
| DCF Mobil                       | 4714              | 42111***       | 23 gal/90 l        | 27.5" x 43.3"/700 x 1100 mm |
| F 20000                         | 4714              | 42111***       | 23 gal/90 l        | 27.5" x 43.3"/700 x 1100 mm |
| F 30000                         | 4714              | 42111***       | 23 gal/90 l        | 27.5" x 43.3"/700 x 1100 mm |

\* Bags are sold in pcss of 10

\*\* Bags are sold in pcss of 4

\*\*\* Bags are sold in pcss of 50

\*\*\*\* Bags are sold individually

All plastic bags are manufactured in strong LD-polyethylene.  
Bag strap, part no 4313, 1 m, part no 4613, 1.5 m.

# www.dustcontrol.com

Contact our Customer Service Department in our Head Office in Norsborg or visit our website for our worldwide distributors for further info, support, service or a demonstration.

## Head Office

Dustcontrol AB  
Box 3088 • Kumla Gårdsväg 14  
145 03 Norsborg, Sweden  
Telephone: +46(0)8 531 940 00  
support@dustcontrol.se  
www.dustcontrol.com

Download our catalogues from Dustcontrol.com



## Save time – use QR codes

There are QR codes on all our mobile machines. Scan the code and you will be able to see videos on filter cleaning and how to replace filters and plastic bags.

No QR reader in your smartphone?  
Download it from the App/Android store

How to use our QR codes?  
See our video on YouTube  
<https://www.youtube.com/watch?v=0BSocYF-6MU>

## Which solution will you choose?

As a true professional, you have high requirements for your equipment. Dustcontrol has been involved with dust extraction and material transport for more than 40 years and we supply dust extractors and air cleaners for all types of applications. No matter what you choose, you can be sure of getting truly professional equipment that is built with your work environment and health in mind.



# Dustcontrol Worldwide



AT

Dustcontrol Ges.m.b.H.  
info@dustcontrol.at  
www.dustcontrol.at



AU

Archquip – All Preparation Equipment  
www.allpreparationequipment.com.au



BENELUX

Dust Solutions BV  
www.dustsolutions.nl



BG

Metaltech14 Ltd.  
metaltex14@abv.bg  
www.dustcontrolbg.com



CA

Dustcontrol Canada Inc.  
info@dustcontrol.ca  
www.dustcontrol.ca



CH

Rosset Technik  
Maschinen Werkzeuge AG  
info@rosset-technik.ch  
www.rosset-technik.ch



CN

Suzhou Dustcollect Filtration  
Technology Co. Ltd.  
wang@dustcollect.cn  
www.dustcollect.cn



CZ / SK

Ener group, a.s.  
Infolinka: +421 918 18 18 87  
www.ener.sk



DE

Dustcontrol GmbH  
info@dustcontrol.de  
www.dustcontrol.de



DK

Erenfred Pedersen A/S  
– Construction  
info@ep.dk  
www.ep.dk



DK

Dansk Procesventilation ApS  
– Industry  
info@dansk-procesventilation.dk  
www.dansk-procesventilation.dk



EE

G-Color Baltic OÜ  
sales@g-color.ee  
www.g-color.ee



ES

Barin, s.a.  
info@barin.es  
www.barin.es



GB

Dustcontrol UK Ltd.  
sales@dustcontrol.co.uk  
www.dustcontrol.co.uk



GR

Mavrogiannakis S.A.  
ektos@internet.gr  
www.ektosoftis.com.gr



FI

Dustcontrol FIN OY  
dc@dustcontrol.fi  
www.dustcontrol.fi



FR

SMH Equipements-Construction  
info@abequipements.com  
www.smhequipements.com



FR

Dustcontrol AB  
info@dustcontrol.fr  
www.dustcontrol.fr



HR

Kermek d.o.o.  
kruno.nedeljko@kermek.com  
www.kermek.com



HU

Vandras Kft  
vandras@t-online.hu  
www.vandras.hu



IN

Advance Ventilation Pve Ltd.  
sales@advanceventilation.com  
www.advanceventilation.com



IT

Airum srl  
info@airum.com  
www.airum.com



KR

ESH Engineering Co.  
– Industry  
eshengco@gmail.com  
www.eshengco.com



KR

Concrete Doctor Co.  
– Construction  
chsw3600@cdr.kr



LT

UAB Hidromega  
info@hidromega.lt  
www.hidromega.lt



LV

SIA Reaktivs  
reaktivs@reaktivs.lv  
www.reaktivs.lv



MY, ID

Stada Envirospace Bhd  
info@stada.com.my  
www.stada.com.my



NO

Teijo Norge A.S.  
firmapost@teijo.no  
www.teijo.no



NZ

Artizan Diamond Tools  
enquiry@artizandiamond.co.nz  
www.artizandiamond.co.nz



PE

Efixo  
contacto@efixo.pe  
www.efixo.pe



PH

Sweden Concrete Machines Inc.  
peringe@packoskick.se  
www.swedenconcretemachines.ph



PL

Bart Sp. z o.o.  
info@bart-vent.pl  
www.bart-vent.pl



PT

Metec-Mecano Técnica, Lda.  
geral@metec.pt  
www.metec.pt



RO

AWS Elektrotechnik  
office@awstehnik.ro  
www.awstehnik.ro



RS

Enel Alati  
eneldoo@eunet.rs  
www.eneldoo.rs



RU

Movers Trading Company LLC  
info@movers-td.ru  
www.movers-td.com



SE

Dustcontrol AB  
support@dustcontrol.se  
www.dustcontrol.com



SG

Stada Envirospace Pte Ltd  
Info@stada.com.my  
www.stada.com.my



TW

Goodland Enterprise Co., Ltd.  
sales@goodland.com.tw  
www.goodland.com.tw



TH

MCON Intertrade Co., Ltd.  
sales@mconintertrade.com  
www.mconintertrade.com



TR

Ventek Mühendislik Ltd.  
info@ventek.com.tr  
www.ventek.com.tr



AE

Global Enterprises Trading Co L.L.C.  
sales@globalentco.com  
www.globalentco.com



AE

GEM  
Industrial Equipment Trading Co.  
Tel: +971 4 8840 474  
Email: gemuae@eim.ae



UA

MBK Obshemashkontrakt, JSC  
zao@omk.dp.ua  
www.omk.dp.ua



US

Dustcontrol Inc.  
info@dustcontrolusa.com  
www.dustcontrol.us



VN

Tayhostar JSC  
tayhostar@tayhostar.vn  
www.tayhostar.vn

**Dustcontrol**

Please contact the headoffice  
in Sweden if you do not find a  
distributor in your area.  
info@dustcontrol.se



# Dustcontrol QR Codes

Easily scanned using a smartphone, QR codes work like quick links, taking you straight to the information you need. We aim to make it easy for you to find information about our products, such as how to replace and clean the filter, or replace the bag. Our QR codes make it easy to find helpful instructional videos in the language of your choice, including English, Swedish, German or Finnish.

To scan the codes, you will need to download a QR code reader app. These can be obtained free of charge via the App Store, Android Market or similar platforms.

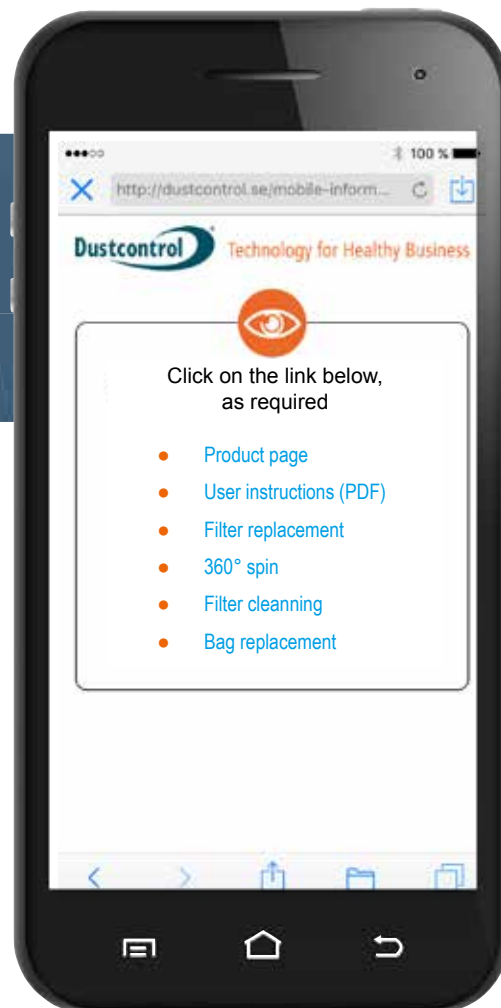

DC Tromb



DC 1800, DC 2800, DC 2900



DC Wet-Vacs



DC AirCubes



DC Storm, DC 5900



DC Accessories FoodIndustry



**How to use our QR codes? See our video on YouTube**

<https://www.youtube.com/watch?v=0BSocYF-6MU>

# Dustcontrol's Environmental and Quality Policy.

**As an environmental company, we have a special responsibility as to how our products and services affect the environment – the external environment, our own working environment and that of our customers. We want to take responsibility for the environment as a whole. We therefore strive to comply with current environmental legislation and to constantly improve our own environmental work.**

It is our responsibility to ensure that all employees are well qualified in environmental issues. We work to identify environmentally friendly modes of transport and company vehicles, and to minimise and separate – at source – the quantity of waste that arises in conjunction with manufacturing.

The entire production cycle is monitored, and we strive to make continuous improvements by finding environmentally friendly alternatives wherever possible. This can include anything from the use of environmentally friendly containers and packaging, to ensuring that the waste Bags are biodegradable. We use a method of powder coating that is free from solvents and minimises waste.

Dustcontrol adheres closely to the EU Reach and RoHS directives in order to reduce the use of chemicals to a minimum. We source only locally produced products for use in the manufacturing operation, in order to minimise freight

costs and reduce CO<sub>2</sub> emissions. We operate with Lean Production to achieve the best possible process flow, with efficient utilisation of resources and reduced lead times.

Our quality should meet the requirements of our customers. This applies equally to product quality, delivery reliability and service. Our customers should know that we listen to their feedback in our ongoing efforts to improve the management system

We update our management system continuously, and Dustcontrol is certified according to ISO14001:2004 and ISO9001:2008.

"Technology for Healthy Business", is an approach that permeates our entire operation. For Dustcontrol, this means: sustainability, financial stability, efficient and effective solutions, physical health and a safe working environment.



## And our Sustainable Values for the Future.

More info  
Download our  
folder from  
[dustcontrol.com](http://dustcontrol.com)

Dustcontrol AB makes every effort to maintain the accuracy and quality of the information provided in this catalogue. However, Dustcontrol AB cannot guarantee and assumes no legal liability or responsibility for the accuracy or completeness of the information provided. The information contained on this catalogue is for general guidance only.

The copyright of all content on this catalogue is owned by Dustcontrol AB. No part of the Dustcontrol AB catalogue may be changed, reproduced, stored in or transmitted on any website or medium without the prior written permission of Dustcontrol AB. Requests to republish any material must be sent to [support@dustcontrol.se](mailto:support@dustcontrol.se). In case of any questions or remarks, feel free to contact us.

Published by Dustcontrol AB 2019 © [www.dustcontrol.com](http://www.dustcontrol.com). 20190913. Prod No 903009.











**Dustcontrol AB** Box 3088, Kumla Gårdsvägen 14,  
SE-145 03 Norsborg, Sweden, Phone +46 8 531 940 00  
[info@dustcontrol.se](mailto:info@dustcontrol.se)

[www.dustcontrol.com](http://www.dustcontrol.com)

Published by Dustcontrol AB 2019 © [www.dustcontrol.com](http://www.dustcontrol.com). Part no 903009